

(8)

20698

T-20725/2022



25/11/22

पश्चिम बंगाल पश्चिम बंगाल WEST BENGAL

2/3324002/22

L 787427

recognition, the signature endorsement sheet or sheets attached with this document are the part of this documents.

[Handwritten Signature]

Additional District Sub-Registrar,
Rajrhat, New Town, North 24-Pgs

23 DEC 2022

DEED OF AMALGAMATION

1. Date : 25th day of November in the year of 2022.
2. Place : Rajarhat, Kolkata.
3. Parties :
 - 3.1. 1) SRI ANGSU PRAKASH MUKHERJEE, (PAN - BFYPM6970D), (Aadhaar No. 4619 1101 0297), Son of Late Rashbehari Mukherjee, residing at Reckjoani, P.O. & P.S. - Rajarhat, Kolkata - 700135, in the District of North 24 Parganas, State - West Bengal, by Faith - Hindu, by Nationality - Indian, Occupation - Retired Person, 2) SRI PRABHAT KUMAR MUKHERJEE @ PRABHAT MUKHERJEE, (PAN - BFYPM6969N), (Aadhaar No. 5699 6717 0241), Son of Late Rashbehari Mukherjee, residing at Reckjoani, P.O. & P.S.

4393 24.11.2022

500f

4393
 24.11.2022
 500f
 998000
 18 NOV 2022
 998000
 18 NOV 2022
 998000

Angsu Prakash Mukherjee
 Reckjoani, P.S. - Rayachhat
 Kolkata - 700135

- Angsu Prakash Mukherjee



12167

- Angsu Prakash Mukherjee



12168

- Pralhat Kumar Mukherjee
 Pralhat Mukherjee



12169

- Arati Mukherjee



12170

- Jaya Chatterjee



Additional District Sub-Registrar,
 Rajarhat, West Town, North 24-Pgs

25 NOV 2022

(2)

- Rajarhat, Kolkata - 700135, in the District of North 24 Parganas, State - West Bengal, by Faith - Hindu, by Nationality - Indian, Occupation - Business, 3) ARATI MUKHERJEE, (PAN - CJTPM5527L), (Aadhaar No. 7647 6867 7115), Daughter of Late Rashbehari Mukherjee, residing at Reckjoani, P.O. & P.S. - Rajarhat, Kolkata -700135, in the District of North 24 Parganas, State - West Bengal, Occupation - House Wife, hereinafter referred and called to as the PARTY (which terms or expression unless excluded by or repugnant to the subject or context, shall mean to include each of his heirs, successors, executors, representatives, administrative and assigns) of the FIRST PART,

AND

3.2. 1) SMT. JAYA CHATTERJEE, (PAN - ARNPC8308H), (Aadhaar No. 5119 9285 7886), Wife of Sri Krishna Das Chatterjee and Daughter of Late Sambhunath Banerjee, residing at Sri Arabinda Sarani, P.O - Hatkhola, P. S. - Shyampukur, Kolkata -700005, Occupation - House Wife, (2) SRI DEBASISH BANERJEE (PAN - BWFPB6878R), (Aadhaar No. 3645 4669 1033), son of Late Sambhu Nath Banerjee, residing at Reckjoani, P.O. & P.S. - Rajarhat, Kolkata - 700135, in the District of North 24 Parganas, State - West Bengal, Occupation - Business, (3) SMT. DOLLY MUKHERJEE, (PAN - BXXPM4021J), (Aadhaar No. 3186 7067 8035), Wife of Sri Subhendu Mukherjee, residing at Reckjoani, P.O. & P.S. - Rajarhat, Kolkata - 700135, in the District of North 24 Parganas, State - West Bengal, Occupation - House Wife, (4) MALLIKA BANERJEE, (PAN - DPDPB5551Q), (Aadhaar No. 9435 6575 5266), Daughter of Late Sambhunath Banerjee, residing at Reckjoani, P.O. & P.S. - Rajarhat, Kolkata - 700135, in the District of North 24 Parganas, State - West Bengal, Occupation - House Wife, all are by Nationality - Indian, by Faith - Hindu, hereinafter referred and called to as the PARTY (which terms or expression unless excluded by or repugnant to the subject or context, shall mean to

(3)

include each of his heirs, successors, executors, representatives, administrative and assigns) of the SECOND PART.

AND

3.3. 1) SRI SAMIR ROY CHOWDHURY, (PAN - BNBPR5027H), (Aadhaar No. 4222 4878 5818), Son of Late Bimal Roy Chowdhury, 2) SRI SOUMEN ROY CHOWDHURY, (PAN - BBZPC3927P), (Aadhaar No. 9721 8102 7550), Son of Sri Samir Roy Chowdhury, 3) SMT. MOUSUMI ROY CHOWDHURY, (PAN - BJLPC9909D), (Aadhaar No. 7493 0643 1762), Wife of Sri Samir Roy Chowdhury, residing at Reckjoani, P.O. & P.S. - Rajarhat, Kolkata - 700135, in the District of North 24 Parganas, State - West Bengal, Occupation - No. 1 Service, No. 2 Student and No. 3 House Wife, all are by Nationality - Indian, by Faith - Hindu, hereinafter referred and called to as the PARTY (which terms or expression unless excluded by or repugnant to the subject or context, shall mean to include each of his heirs, successors, executors, representatives, administrative and assigns) of the THIRD PART.

4 Background, Representations, Warranties and Covenants :

4.1. Representations and Warranties Regarding Title : The Land Owners have made the following representation and given the following warranty for amalgamation.

4.1.1. Absolute ownership of Angsu Prakash Mukherjee, Prabhat Kumar Mukherjee @ Prabhat Mukherjee and Arati Mukherjee (First Part herein) : Angsu Prakash Mukherjee, Prabhat Kumar Mukherjee @ Prabhat Mukherjee and Arati Mukherjee (First Part herein) are the absolute owner of Bastu land measuring an area of 08 (Eight) Decimals of land in R.S. & L.R. Dag No. 1313, under L.R. Khatian No. 9191, Bastu land measuring an area of

(4)

08.70 (Eight point Seven Zero) Decimals of land in R.S. & L.R. Dag No. 1313, under L.R. Khatian No. 1980, Bastu land measuring an area of 08.54 (Eight point Five Four) Decimals of land in R.S. & L.R. Dag No. 1313, under L.R. Khatian No. 7914, measuring an area of 08 (Eight) Decimals of land in R.S. & L.R. Dag No. 1313, under L.R. Khatian No. 9190, Bastu land measuring an area of 05.625 (Five point Six Two Five) Decimals of land in R.S. & L.R. Dag No. 1313/1815, under L.R. Khatian No. 1980, Bastu land measuring an area of 01.875 (One point Eight Seven Five) Decimals of land in R.S. & L.R. Dag No. 1313/1815, under L.R. Khatian No. 7914, Pukur measuring an area of 09 (Nine) Decimals of land in R.S. & L.R. Dag No. 1312, under L.R. Khatian No. 1981, Pukur measuring an area of 09 (Nine) Decimals of land in R.S. & L.R. Dag No. 1312, under L.R. Khatian No. 1980 and Pukur measuring an area of 03 (Three) Decimals of land in R.S. & L.R. Dag No. 1312, under L.R. Khatian No. 7914, total measuring an area of 61.74 (Sixty One point Seven Four) Decimals of land, under Sabek Khatian No. 1318, R.S. Khatian No. 1467, situated at Mouza - Reckjoani, J.L. 13, Re. Sa. 198, Touzi 2998 at present 10, Pargana Kolikata, P.S. Rajarhat, A.D.S.R. Office Bidhannagar (Salt Lake City) at present A.D.S.R. Office Rajarhat, under local limit of Rajarhat Bishnupur 1 No. Gram Panchayet, in the District of North 24 Parganas and have been enjoying and possessing the aforesaid land by paying B.L & L.R.O Rent and Panchayet taxes accordingly and the said land is free from all encumbrances charges, liens and mortgage whatsoever.

4.1.2. ABSOLUTE OWNERSHIP OF SAID PROPERTY :

In the above mentioned circumstances, the Land Owners Angsu Prakash Mukherjee, Prabhat Kumar Mukherjee @ Prabhat Mukherjee and Arati Mukherjee (First Part herein) have become the undisputed and absolute owners

(5)

of the said Property as follows :

<u>Land Owner</u>	<u>R.S. & L.R.</u>	<u>L.R.</u>	<u>Area</u>
<u>Name</u>	<u>Dag No.</u>	<u>Khatian No.</u>	<u>Decimals</u>
Angsu Prakash Mukherjee	1313	9191	08
Prabhat Kumar Mukherjee	1313	1980	08.70
@ Prabhat Mukherjee			
Arati Mukherjee	1313	7914	08.54
Arati Mukherjee	1313	9190	08
Prabhat Kumar Mukherjee	1313/1815	1980	5.625
@ Prabhat Mukherjee			
Arati Mukherjee	1313/1815	7914	1.875
Angsu Prakash Mukherjee	1312	1981	09
Prabhat Kumar Mukherjee	1312	1980	09
@ Prabhat Mukherjee			
Arati Mukherjee	1312	7914	03

Total area of 61.74 Decimals more or less.

4.1.3. Absolute ownership of Smt. Jaya Chatterjee, Sri Debasish Banerjee, Smt. Dolly Mukherjee and Mallika Banerjee (Second Part herein) : Smt. Jaya Chatterjee, Sri Debasish Banerjee, Smt. Dolly Mukherjee and Mallika Banerjee (Second Part herein) are the absolute owner of measuring an area of 02.14 (Two point One Four) Decimals of land in R.S. & L.R. Dag No. 1313, under L.R. Khatian No. 8178, measuring an area of 02.14 (Two point One Four) Decimals of land in R.S. & L.R. Dag No. 1313, under L.R. Khatian

(6)

No. 8177, measuring an area of 02.14 (Two point One Four) Decimals of land in R.S. & L.R. Dag No. 1313, under L.R. Khatian No. 8179, measuring an area of 02.12 (Two point One Two) Decimals of land in R.S. & L.R. Dag No. 1313, under L.R. Khatian No. 8180, measuring an area of 0.468 (point Four Six Eight) Decimals of land in R.S. & L.R. Dag No. 1313/1815, under L.R. Khatian No. 8178, measuring an area of 0.468 (point Four Six Eight) Decimals of land in R.S. & L.R. Dag No. 1313/1815, under L.R. Khatian No. 8177, measuring an area of 0.4695 (point Four Six Nine Five) Decimals of land in R.S. & L.R. Dag No. 1313/1815, under L.R. Khatian No. 8179, measuring an area of 0.4695 (point Four Six Nine Five) Decimals of land in R.S. & L.R. Dag No. 1313/1815, under L.R. Khatian No. 8180, measuring an area of 0.7512 (point Seven Five One Two) Decimals of land in R.S. & L.R. Dag No. 1312, under L.R. Khatian No. 8178, measuring an area of 0.7512 (point Seven Five One Two) Decimals of land in R.S. & L.R. Dag No. 1312, under L.R. Khatian No. 8177, measuring an area of 0.7488 (point Seven Four Eight Eight) Decimals of land in R.S. & L.R. Dag No. 1312, under L.R. Khatian No. 8179, measuring an area of 0.7488 (point Seven Four Eight Eight) Decimals of land in R.S. & L.R. Dag No. 1312, under L.R. Khatian No. 8180, under Sabek Khatian No. 1318, R.S. Khatian No. 1467, total measuring an area 13.415 (Thirteen point Four One Five) Decimals more or less, situated at Mouza - Reckjoani, J.L. 13, Re. Sa. 198, Touzi 2998 at present 10, Pargana Kolikata, P.S. Rajarhat, A.D.S.R. Office Bidhannagar (Salt Lake City) at present A.D.S.R. Office Rajarhat, under local limit of Rajarhat Bishnupur 1 No. Gram Panchayet, in the District of North 24 Parganas and have been enjoying and possessing the aforesaid land by paying B.L & L.R.O Rent and Panchayet taxes accordingly and the said land is free from all encumbrances charges, liens and mortgage whatsoever.

(7)

4.1.4. ABSOLUTE OWNERSHIP OF SAID PROPERTY :

In the above mentioned circumstances, the Land Owners Smt. Jaya Chatterjee, Sri Debasish Banerjee, Smt. Dolly Mukherjee and Mallika Banerjee (Second Part herein) have become the undisputed and absolute owners of the said Property as follows :

<u>Land Owner</u>	<u>R.S. & L.R.</u>	<u>L.R.</u>	<u>Area</u>
<u>Name</u>	<u>Dag No.</u>	<u>Khatian No.</u>	<u>Decimals</u>
Jaya Chatterjee	1313	8178	02.14
Debasish Banerjee	1313	8177	02.14
Dolly Mukherjee	1313	8179	02.14
Mallika Banerjee	1313	8180	02.12
Jaya Chatterjee	1313/1815	8178	0.468
Debasish Banerjee	1313/1815	8177	0.468
Dolly Mukherjee	1313/1815	8179	0.4695
Mallika Banerjee	1313/1815	8180	0.4695
Jaya Chatterjee	1312	8178	0.7512
Debasish Banerjee	1312	8177	0.7512
Dolly Mukherjee	1312	8179	0.7488
Mallika Banerjee	1312	8180	0.7488

Total area of 13.415 (Thirteen point Four One Five) Decimals

4.1.5. Absolute ownership of Sri Samir Roy Chowdhury, Sri Soumen Roy Chowdhury, Smt. Mousumi Roy Chowdhury (Third Part herein) : Sri Samir Roy Chowdhury, Sri Soumen Roy Chowdhury, Smt. Mousumi Roy Chowdhury (Third Part herein) are the absolute owners of Bastu land measuring an area of 08 (Eight) Decimals of land in R.S. & L.R. Dag No. 1313, under L.R. Khatian

(8)

No. 9182, Bastu land measuring an area of 07.70 (Seven point Seven Zero) Decimals of land in R.S. & L.R. Dag No. 1313, under L.R. Khatian No. 9183, Bastu land measuring an area of 08 (Eight) Decimals of land in R.S. & L.R. Dag No. 1313, under L.R. Khatian No. 9181, measuring an area of 08 (Eight) Decimals of land in R.S. & L.R. Dag No. 1313, under L.R. Khatian No. 9169, Bastu land measuring an area of 05.625 (Five point Six Two Five) Decimals of land in R.S. & L.R. Dag No. 1313/1815, under L.R. Khatian No. 9183, under Sabek Khatian No. 1318, R.S. Khatian No. 1467, total measuring an area 37.325 (Thirty Seven point Three Two Five) Decimals more or less, situated at Mouza - Reckjoani, J.L. 13, Re. Sa. 198, Touzi 2998 at present 10, Pargana Kolikata, P.S. Rajarhat, A.D.S.R. Office Bidhannagar (Salt Lake City) at present A.D.S.R. Office Rajarhat, under local limit of Rajarhat Bishnupur 1 No. Gram Panchayet, in the District of North 24 Parganas and have been enjoying and possessing the aforesaid land by paying B.L & L.R.O Rent and Panchayet taxes accordingly and the said land is free from all encumbrances charges, liens and mortgage whatsoever.

4.1.6. ABSOLUTE OWNERSHIP OF SAID PROPERTY : In the above mentioned circumstances, the Land Owners Sri Samir Roy Chowdhury, Sri Soumen Roy Chowdhury, Smt. Mousumi Roy Chowdhury (Third Part herein) have become the undisputed and absolute owners of the said Property as follows

<u>Land Owner</u>	<u>R.S. & L.R.</u>	<u>L.R.</u>	<u>Area</u>
<u>Name</u>	<u>Dag No.</u>	<u>Khatian No.</u>	<u>Decimals</u>
Samir Roy Chowdhury	1313	9182	08
Samir Roy Chowdhury	1313	9183	07.70
Soumen Roy Chowdhury	1313	9181	08
Mousumi Roy Chowdhury	1313	9169	08

(9)

Samir Roy Chowdhury

1313/1815

9183

05.625

Total area of 37.325 (Thirty Seven point Three Two Five) Decimals

4.1.7. ABSOLUTE OWNERSHIP OF SAID PROPERTY : In the above mentioned circumstances, the Land Owners have become the undisputed and absolute owners of the said Property as follows :

<u>Land Owner</u> <u>Name</u>	<u>R.S. & L.R.</u> <u>Dag No.</u>	<u>L.R.</u> <u>Khatian No.</u>	<u>Area</u> <u>Decimals</u>
Angsu Prakash Mukherjee	1313	9191	08
Prabhat Kumar Mukherjee	1313	1980	08.70
@ Prabhat Mukherjee			
Arati Mukherjee	1313	7914	08.54
Arati Mukherjee	1313	9190	08
Prabhat Kumar Mukherjee	1313/1815	1980	5.625
@ Prabhat Mukherjee			
Arati Mukherjee	1313/1815	7914	1.875
Angsu Prakash Mukherjee	1312	1981	09
Prabhat Kumar Mukherjee	1312	1980	09
@ Prabhat Mukherjee			
Arati Mukherjee	1312	7914	03
Jaya Chatterjee	1313	8178	02.14
Debasish Banerjee	1313	8177	02.14
Dolly Mukherjee	1313	8179	02.14
Mallika Banerjee	1313	8180	02.12
Jaya Chatterjee	1313/1815	8178	0.468
Debasish Banerjee	1313/1815	8177	0.468
Dolly Mukherjee	1313/1815	8179	0.4695

(10)

Mallika Banerjee	1313/1815	8180	0.4695
Jaya Chatterjee	1312	8178	0.7512
Debasish Banerjee	1312	8177	0.7512
Dolly Mukherjee	1312	8179	0.7488
Mallika Banerjee	1312	8180	0.7488
Samir Roy Chowdhury	1313	9182	08
Samir Roy Chowdhury	1313	9183	07.70
Soumen Roy Chowdhury	1313	9181	08
Mousumi Roy Chowdhury	1313	9169	08
Samir Roy Chowdhury	1313/1815	9183	05.625

112.48 Decimals

4.1.8. The aforesaid Plots of land of among the parties herein are contiguous, adjacent, interlinked, interconnected and situated at the same Mouza also under in the same jurisdiction of the Rajarhat Bishnupur I No. Gram Panchayet, P.S. Rajarhat, A.D.S.R. Office at Bidhannagar (Salt Lake City) present A.D.S.R. Office at Rajarhat and all the parties of this present have been possessing their respective plot of land without any interruption of others.

5. NOW THIS INDENTURE WITNESSETH as follows :

i That upon execution of this present the party of the **First Part** herein, amalgamates their plot of land measuring an area of **08 (Eight) Decimals** of land in R.S. & L.R. Dag No. 1313, under L.R. Khatian No. 9191, Bastu land measuring an area of **08.70 (Eight point Seven Zero) Decimals** of land in R.S. & L.R. Dag No. 1313, under L.R. Khatian No. 1980, Bastu land measuring an area of **08.54 (Eight point Five Four) Decimals** of land in R.S. & L.R. Dag No. 1313, under L.R. Khatian No. 7914, measuring an area of **08 (Eight) Decimals** of land in R.S. & L.R. Dag No. 1313, under L.R. Khatian No.

(11)

9190, Bastu land measuring an area of 05.625 (Five point Six Two Five) Decimals of land in R.S. & L.R. Dag No. 1313/1815, under L.R. Khatian No. 1980, Bastu land measuring an area of 01.875 (One point Eight Seven Five) Decimals of land in R.S. & L.R. Dag No. 1313/1815, under L.R. Khatian No. 7914, Pukur measuring an area of 09 (Nine) Decimals of land in R.S. & L.R. Dag No. 1312, under L.R. Khatian No. 1981, Pukur measuring an area of 09 (Nine) Decimals of land in R.S. & L.R. Dag No. 1312, under L.R. Khatian No. 1980 and Pukur measuring an area of 03 (Three) Decimals of land in R.S. & L.R. Dag No. 1312, under L.R. Khatian No. 7914, total measuring an area of 61.74 (Sixty One point Seven Four) Decimals of land, under Sabek Khatian No. 1318, R.S. Khatian No. 1467, situated at Mouza - Reckjoani, J.L. 13, Re. Sa. 198, Touzi 2998 at present 10, Pargana Kolikata, P.S. Rajarhat, A.D.S.R. Office at Bidhannagar (Salt Lake City) present A.D.S.R. Office at Rajarhat, under local limit of Rajarhat Bishnupur 1 No. Gram Panchayet in the District of North 24 Parganas, morefully and particularly described in the Schedule "A" herein below, with the land of the party of the Second Part herein measuring an area of 02.14 (Two point One Four) Decimals of land in R.S. & L.R. Dag No. 1313, under L.R. Khatian No. 8178, measuring an area of 02.14 (Two point One Four) Decimals of land in R.S. & L.R. Dag No. 1313, under L.R. Khatian No. 8177, measuring an area of 02.14 (Two point One Four) Decimals of land in R.S. & L.R. Dag No. 1313, under L.R. Khatian No. 8179, measuring an area of 02.12 (Two point One Two) Decimals of land in R.S. & L.R. Dag No. 1313, under L.R. Khatian No. 8180, measuring an area of 0.468 (point Four Six Eight) Decimals of land in R.S. & L.R. Dag No. 1313/1815, under L.R. Khatian No. 8178, measuring an area of 0.468 (point Four Six Eight) Decimals of land in R.S. & L.R. Dag No. 1313/1815, under L.R. Khatian No. 8177, measuring an area of 0.4695 (point Four Six Nine Five) Decimals of land in R.S. & L.R.

(12)

Dag No. 1313/1815, under L.R. Khatian No. 8179, measuring an area of 0.4695 (point Four Six Nine Five) Decimals of land in R.S. & L.R. Dag No. 1313/1815, under L.R. Khatian No. 8180, measuring an area of 0.7512 (point Seven Five One Two) Decimals of land in R.S. & L.R. Dag No. 1312, under L.R. Khatian No. 8178, measuring an area of 0.7512 (point Seven Five One Two) Decimals of land in R.S. & L.R. Dag No. 1312, under L.R. Khatian No. 8177, measuring an area of 0.7488 (point Seven Four Eight Eight) Decimals of land in R.S. & L.R. Dag No. 1312, under L.R. Khatian No. 8179, measuring an area of 0.7488 (point Seven Four Eight Eight) Decimals of land in R.S. & L.R. Dag No. 1312, under L.R. Khatian No. 8180, under Sabek Khatian No. 1318, R.S. Khatian No. 1467, total measuring an area 13.415 (Thirteen point Four One Five) Decimals more or less, situated at Mouza - Reckjoani, J.L. 13, Re. Sa. 198, Touzi 2998 at present 10, Pargana Kolikata, P.S. Rajarhat, A.D.S.R. Office at Bidhannagar (Salt Lake City) present A.D.S.R. Office at Rajarhat, under local limit of Rajarhat Bishnupur 1 No. Gram Panchayet in the District of North 24 Parganas, morefully and particularly described in the Schedule "B" herein below, with the land of the party of the Third Part herein measuring an area measuring an area of 08 (Eight) Decimals of land in R.S. & L.R. Dag No. 1313, under L.R. Khatian No. 9182, Bastu land measuring an area of 07.70 (Seven point Seven Zero) Decimals of land in R.S. & L.R. Dag No. 1313, under L.R. Khatian No. 9183, Bastu land measuring an area of 08 (Eight) Decimals of land in R.S. & L.R. Dag No. 1313, under L.R. Khatian No. 9181, measuring an area of 08 (Eight) Decimals of land in R.S. & L.R. Dag No. 1313, under L.R. Khatian No. 9169, Bastu land measuring an area of 05.625 (Five point Six Two Five) Decimals of land in R.S. & L.R. Dag No. 1313/1815, under L.R. Khatian No. 9183, under Sabek Khatian No. 1318, R.S. Khatian No. 1467, total measuring an area 37.325 (Thirty Seven point Three

(13)

Two Five) Decimals, situated at Mouza - Reckjoani, J.L. 13, Re. Sa. 198, Touzi 2998 at present 10, Pargana Kolikata, P.S. Rajarhat, A.D.S.R. Office at Bidhannagar (Salt Lake City) present A.D.S.R. Office at Rajarhat, under local limit of Rajarhat Bishnupur 1 No. Gram Panchayet in the District of North 24 Parganas, morefully and particularly described in the Schedule "C" herein below.

ii. To avail maximum F.A.R. and also for the purpose of the commercial exploitation and/or Development, all the Parties herein amalgamates their respective Plot of land into a single Plot of land AND they will be prepared a single plan which will be sanctioned by the Rajarhat Bishnupur 1 No. Gram Panchayet/Rajarhat Panchayet Samity/North 24 Parganas Zella Parished and other authority.

iii. That the property of the Schedule "A, B & C" herein below shall be treated as a single plot under the local limit of the Rajarhat Bishnupur 1 No. Gram Panchayet, comprising in R.S. & L.R. Dag No. 1313, 1313/1815 & 1312, under Sabek Khatian No. 1318, R.S. Khatian No. 1467, present L. R. Khatian No. 9191, 1980, 7914, 9190, 1981, 8178, 8177, 8179, 8180, 9182, 9183, 9181, 9169, lying and situated at Mouza - Reckjoani, J.L. 13, Re. Sa. 198, Touzi 2998 at present 10, Pargana Kolikata, P.S. Rajarhat, A.D.S.R. Office Bidhannagar (Salt Lake City) at present A.D.S.R. Office at Rajarhat, under local limit of Rajarhat Bishnupur 1 No. Gram Panchayet in the District of North 24 Parganas. The original landlord of which is the Govt. of West Bengal being represented by the Collector of North 24 Parganas morefully and particularly described in the Schedule "D" below. All the parties herein shall became the joint owners and shall have proportionate undivided share in respect of the entire "D" Schedule property.

iv. That both the parties herein shall mutate their names with the Assessment Register of Rajarhat Bishnupur 1 No. Gram Panchayet as well as in the records of Land Revenue Department, Govt. of West Bengal as the joint owners of the said amalgamated plot of land described in Schedule "D" below.

(14)

v. That all the parties of this presents shall do every such acts, deeds and things as shall reasonably be required for further or more perfectly amalgamating the "D" Schedule property.

vi. That all the parties of this present shall never raise any objection against each other before the Rajarhat Bishnupur 1 No. Gram Panchayet or any other authority in the case of amalgamation of the Schedule "A", "B", and "C" property into a single holding described in the Schedule "D" herein below.

vii. That all the parties herein of this Deed shall pay their proportionate share of rents and taxes in the concerned offices in respect of the amalgamated "D" Schedule property.

"A" SCHEDULE OF THE PROPERTY

(Property of the First Part)

ALL THAT piece and parcel of Bastu land measuring an area of 08 (Eight) Decimals of land in R.S. & L.R. Dag No. 1313, under L.R. Khatian No. 9191, Bastu land measuring an area of 08.70 (Eight point Seven Zero) Decimals of land in R.S. & L.R. Dag No. 1313, under L.R. Khatian No. 1980, Bastu land measuring an area of 08.54 (Eight point Five Four) Decimals of land in R.S. & L.R. Dag No. 1313, under L.R. Khatian No. 7914, measuring an area of 08 (Eight) Decimals of land in R.S. & L.R. Dag No. 1313, under L.R. Khatian No. 9190, Bastu land measuring an area of 05.625 (Five point Six Two Five) Decimals of land in R.S. & L.R. Dag No. 1313/1815, under L.R. Khatian No. 1980, Bastu land measuring an area of 01.875 (One point Eight Seven Five) Decimals of land in R.S. & L.R. Dag No. 1313/1815, under L.R. Khatian No. 7914, Pukur measuring an area of 09 (Nine) Decimals of land in R.S. & L.R. Dag No. 1312, under L.R. Khatian No. 1981, Pukur measuring an area of 09 (Nine) Decimals of land in R.S. & L.R. Dag No. 1312, under L.R. Khatian

(15)

No. 1980 and Pukur measuring an area of 03 (Three) Decimals of land in R.S. & L.R. Dag No. 1312, under L.R. Khatian No. 7914, total measuring an area of 61.74 (Sixty One point Seven Four) Decimals of land with 750 Square Feet Cemented Floor residential Pucca one storied structure, under Sabek Khatian No. 1318, R.S. Khatian No. 1467, situated at Mouza - Reckjoani, J.L. 13, Re. Sa. 198, Touzi 2998 at present 10, Pargana Kolikata, P.S. Rajarhat, A.D.S.R. Office Bidhannagar (Salt Lake City) at present A.D.S.R. Office Rajarhat, under local limit of Rajarhat Bishnupur 1 No. Gram Panchayet, in the District of North 24 Parganas. The original land lord which is the Government of West Bengal represented by the Collector of the North 24 Parganas.

<u>Land Owner</u>	<u>R.S. & L.R.</u>	<u>L.R.</u>	<u>Area</u>
<u>Name</u>	<u>Dag No.</u>	<u>Khatian No.</u>	<u>Decimals</u>
Angsu Prakash Mukherjee	1313	9191	08
Prabhat Kumar Mukherjee	1313	1980	08.70
@ Prabhat Mukherjee			
Arati Mukherjee	1313	7914	08.54
Arati Mukherjee	1313	9190	08
Prabhat Kumar Mukherjee	1313/1815	1980	5.625
@ Prabhat Mukherjee			
Arati Mukherjee	1313/1815	7914	1.875
Angsu Prakash Mukherjee	1312	1981	09
Prabhat Kumar Mukherjee	1312	1980	09
@ Prabhat Mukherjee			
Arati Mukherjee	1312	7914	03

Total area of land 61.74 Decimals.

(16)

"B" SCHEDULE OF THE PROPERTY

(Property of the Second Part)

ALL THAT piece and parcel of Bastu land measuring an area of 02.14 (Two point One Four) Decimals of land in R.S. & L.R. Dag No. 1313, under L.R. Khatian No. 8178, measuring an area of 02.14 (Two point One Four) Decimals of land in R.S. & L.R. Dag No. 1313, under L.R. Khatian No. 8177, measuring an area of 02.14 (Two point One Four) Decimals of land in R.S. & L.R. Dag No. 1313, under L.R. Khatian No. 8179, measuring an area of 02.12 (Two point One Two) Decimals of land in R.S. & L.R. Dag No. 1313, under L.R. Khatian No. 8180, measuring an area of 0.468 (point Four Six Eight) Decimals of land in R.S. & L.R. Dag No. 1313/1815, under L.R. Khatian No. 8178, measuring an area of 0.468 (point Four Six Eight) Decimals of land in R.S. & L.R. Dag No. 1313/1815, under L.R. Khatian No. 8177, measuring an area of 0.4695 (point Four Six Nine Five) Decimals of land in R.S. & L.R. Dag No. 1313/1815, under L.R. Khatian No. 8179, measuring an area of 0.4695 (point Four Six Nine Five) Decimals of land in R.S. & L.R. Dag No. 1313/1815, under L.R. Khatian No. 8180, measuring an area of 0.7512 (point Seven Five One Two) Decimals of land in R.S. & L.R. Dag No. 1312, under L.R. Khatian No. 8178, measuring an area of 0.7512 (point Seven Five One Two) Decimals of land in R.S. & L.R. Dag No. 1312, under L.R. Khatian No. 8177, measuring an area of 0.7488 (point Seven Four Eight Eight) Decimals of land in R.S. & L.R. Dag No. 1312, under L.R. Khatian No. 8179, measuring an area of 0.7488 (point Seven Four Eight Eight) Decimals of land in R.S. & L.R. Dag No. 1312, under L.R. Khatian No. 8180, under Sabek Khatian No. 1318, R.S. Khatian No. 1467, total measuring an area 13.415 (Thirteen point Four One Five) Decimals more or less, with 750 Square Feet Cemented Floor residential Pucca one storied structure, situated at Mouza - Reckjoani, J.L. 13, Re. Sa. 198,

(17)

Touzi 2998 at present 10, Pargana Kolikata, P.S. Rajarhat, A.D.S.R. Office Bidhannagar (Salt Lake City) at present A.D.S.R. Office Rajarhat, under local limit of Rajarhat Bishnupur 1 No. Gram Panchayet, in the District of North 24 Parganas. The original land lord which is the Government of West Bengal represented by the Collector of the North 24 Parganas.

<u>Land Owner</u>	<u>R.S. & L.R.</u>	<u>L.R.</u>	<u>Area</u>
<u>Name</u>	<u>Dag No.</u>	<u>Khatian No.</u>	<u>Decimals</u>
Jaya Chatterjee	1313	8178	02.14
Debasish Banerjee	1313	8177	02.14
Dolly Mukherjee	1313	8179	02.14
Mallika Banerjee	1313	8180	02.12
Jaya Chatterjee	1313/1815	8178	0.468
Debasish Banerjee	1313/1815	8177	0.468
Dolly Mukherjee	1313/1815	8179	0.4695
Mallika Banerjee	1313/1815	8180	0.4695
Jaya Chatterjee	1312	8178	0.7512
Debasish Banerjee	1312	8177	0.7512
Dolly Mukherjee	1312	8179	0.7488
Mallika Banerjee	1312	8180	0.7488

Total area of land 13.415 (Thirteen point Four One Five) Decimals.

"C" SCHEDULE OF THE PROPERTY

(Property of the Third Part)

ALL THAT piece and parcel of Bastu vacant land measuring an area of 08 (Eight) Decimals of land in R.S. & L.R. Dag No. 1313, under L.R. Khatian No. 9182, Bastu land measuring an area of 07.70 (Seven point Seven Zero) Decimals of land in R.S. & L.R. Dag No. 1313, under L.R. Khatian No.

(18)

9183, Bastu land measuring an area of 08 (Eight) Decimals of land in R.S. & L.R. Dag No. 1313, under L.R. Khatian No. 9181, measuring an area of 08 (Eight) Decimals of land in R.S. & L.R. Dag No. 1313, under L.R. Khatian No. 9169, Bastu land measuring an area of 05.625 (Five point Six Two Five) Decimals of land in R.S. & L.R. Dag No. 1313/1815, under L.R. Khatian No. 9183, under Sabek Khatian No. 1318, R.S. Khatian No. 1467, total measuring an area 37.325 (Thirty Seven point Three Two Five) Decimals more or less, situated at Mouza - Reckjoani, J.L. 13, Re. Sa. 198, Touzi 2998 at present 10, Pargana Kolikata, P.S. Rajarhat, A.D.S.R. Office Bidhannagar (Salt Lake City) at present A.D.S.R. Office Rajarhat, under local limit of Rajarhat Bishnupur 1 No. Gram Panchayet, in the District of North 24 Parganas. The original land lord which is the Government of West Bengal represented by the Collector of the North 24 Parganas. There is no structure of the this land.

<u>Land Owner</u>	<u>R.S. & L.R.</u>	<u>L.R.</u>	<u>Area</u>
<u>Name</u>	<u>Dag No.</u>	<u>Khatian No.</u>	<u>Decimals</u>
Samir Roy Chowdhury	1313	9182	08
Samir Roy Chowdhury	1313	9183	07.70
Soumen Roy Chowdhury	1313	9181	08
Mousumi Roy Chowdhury	1313	9169	08
Samir Roy Chowdhury	1313/1815	9183	05.625

Total area of 37.325 (Thirty Seven point Three Two Five) Decimals more or less.

"D" SCHEDULE OF THE PROPERTY

(The Amalgamated Property)

ALL THAT piece and parcel of Bastu land measuring an area of 73.48 (Seventy

(19)

Three point Four Eight) Decimals of land in R.S. & L.R. Dag No. 1313, under L.R. Khatian No. 9191, 1980, 7914, 9190, 8178, 8177, 8179, 8180, 9182, 9183, 9181 & 9169, Bastu land measuring an area of 15 (Fifteen) Decimals of land in R.S. & L.R. Dag No. 1313/1815, under L.R. Khatian No. 1980, 7914, 8178, 8177, 8179, 8180 & 9183, measuring an area of Pukur 24 (Twenty Four) Decimals of land in R.S. & L.R. Dag No. 1312, under L.R. Khatian No. 1980, 7914, 8178, 8177, 8179, 8180 & 9183, under Sabek Khatian No. 1318, R.S. Khatian No. 1467, total measuring an area 112.48 (One Hundred Twelve point Four Eight) Decimals more or less, with 1500 Square Feet Cemented Floor residential Pucca one storied structure, situated at Mouza - Reckjoani, J.L. 13, Re. Sa. 198, Touzi 2998 at present 10, Pargana Kolikata, P.S. Rajarhat, A.D.S.R. Office Bidhannagar (Salt Lake City) at present A.D.S.R. Office Rajarhat, under local limit of Rajarhat Bishnupur 1 No. Gram Panchayet, in the District of North 24 Parganas. The original land lord which is the Government of West Bengal represented by the Collector of the North 24 Parganas.

<u>Land Owner</u>	<u>R.S. & L.R.</u>	<u>L.R.</u>	<u>Area</u>
<u>Name</u>	<u>Dag No.</u>	<u>Khatian No.</u>	<u>Decimals</u>
Angsu Prakash Mukherjee	1313	9191	08
Prabhat Kumar Mukherjee	1313	1980	08.70
@ Prabhat Mukherjee			
Arati Mukherjee	1313	7914	08.54
Arati Mukherjee	1313	9190	08
Prabhat Kumar Mukherjee	1313/1815	1980	5.625
@ Prabhat Mukherjee			
Arati Mukherjee	1313/1815	7914	1.875
Angsu Prakash Mukherjee	1312	1981	09
Prabhat Kumar Mukherjee	1312	1980	09

(20)

@ Prabhat Mukherjee

Arati Mukherjee	1312	7914	03
Jaya Chatterjee	1313	8178	02.14
Debasish Banerjee	1313	8177	02.14
Dolly Mukherjee	1313	8179	02.14
Mallika Banerjee	1313	8180	02.12
Jaya Chatterjee	1313/1815	8178	0.468
Debasish Banerjee	1313/1815	8177	0.468
Dolly Mukherjee	1313/1815	8179	0.4695
Mallika Banerjee	1313/1815	8180	0.4695
Jaya Chatterjee	1312	8178	0.7512
Debasish Banerjee	1312	8177	0.7512
Dolly Mukherjee	1312	8179	0.7488
Mallika Banerjee	1312	8180	0.7488
Samir Roy Chowdhury	1313	9182	08
Samir Roy Chowdhury	1313	9183	07.70
Soumen Roy Chowdhury	1313	9181	08
Mousumi Roy Chowdhury	1313	9169	08
Samir Roy Chowdhury	1313/1815	9183	05.625

112.48 Decimals

The Amalgamated Property Butted and Bounded by

- ON THE NORTH : R.S. & L.R. Dag No. 1313.
ON THE SOUTH : R.S. & L.R. Dag No. 1313.
ON THE EAST : R.S. & L.R. Dag No. 1310 & 1311.
ON THE WEST : 25' Feet wide Panchayet Road.

(21)

IN WITNESS WHEREOF THE PARTIES the parties hereto of the First Part, Second Part and Third Part have put their respective hands and seals the day, month and year written at the outset.

- Anurag Prakash Mukherjee
Prabhat Kumar Mukherjee
Prabhat Mukherjee
Anurag Mukherjee

SIGNATURE OF THE FIRST PART

- Jaya Chatterjee

- Sumantra Banerjee

- Dolly Mukherjee

- Mallika Banerjee

SIGNATURE OF THE SECOND PART

Samir Roy Chowdhury

Soumen Roy Chowdhury

সমীর রায় চৌধুরী

SIGNATURE OF THE THIRD PART

Drafted, Read and Explained by:

Rani Kana Das
Rani Kana Das
Advocate
En No. - 708/707/90
Barasat Judges' Court
Barasat, North 24 Parganas

Computer by:

Timirbaran Mandal
Timirbaran Mandal

Kanjial Para, Rajarhat.

WITNESSES

1. Timirbaran Mandal
Kanjialpara, Rajarhat,
Kolkata - 700135.

2. Pranab Kr. Roychoudhury
Rachjorani, Rajarhat
Kolkata - 135.



SITE PLAN OF R.S. & L.R. DAG NO. - 1312, 1313(P), 1313/1815, AT MOUZA - REKJUANI, JL NO. - 13, R.S. NO. - 198, L.R. KHATIAN NOS. - 1980, 1981, 7914, 8177, 8178, 8179, 8180, 9169, 9181, 9182, 9183, 9190, 9191, P.S. - RAJARHAT, DIST. - NORTH 24 PARGANAS UNDER RAJARHAT - BISHNUPUR 1 NO. GRAM PANCHAYET.

PANCHAYET ROAD

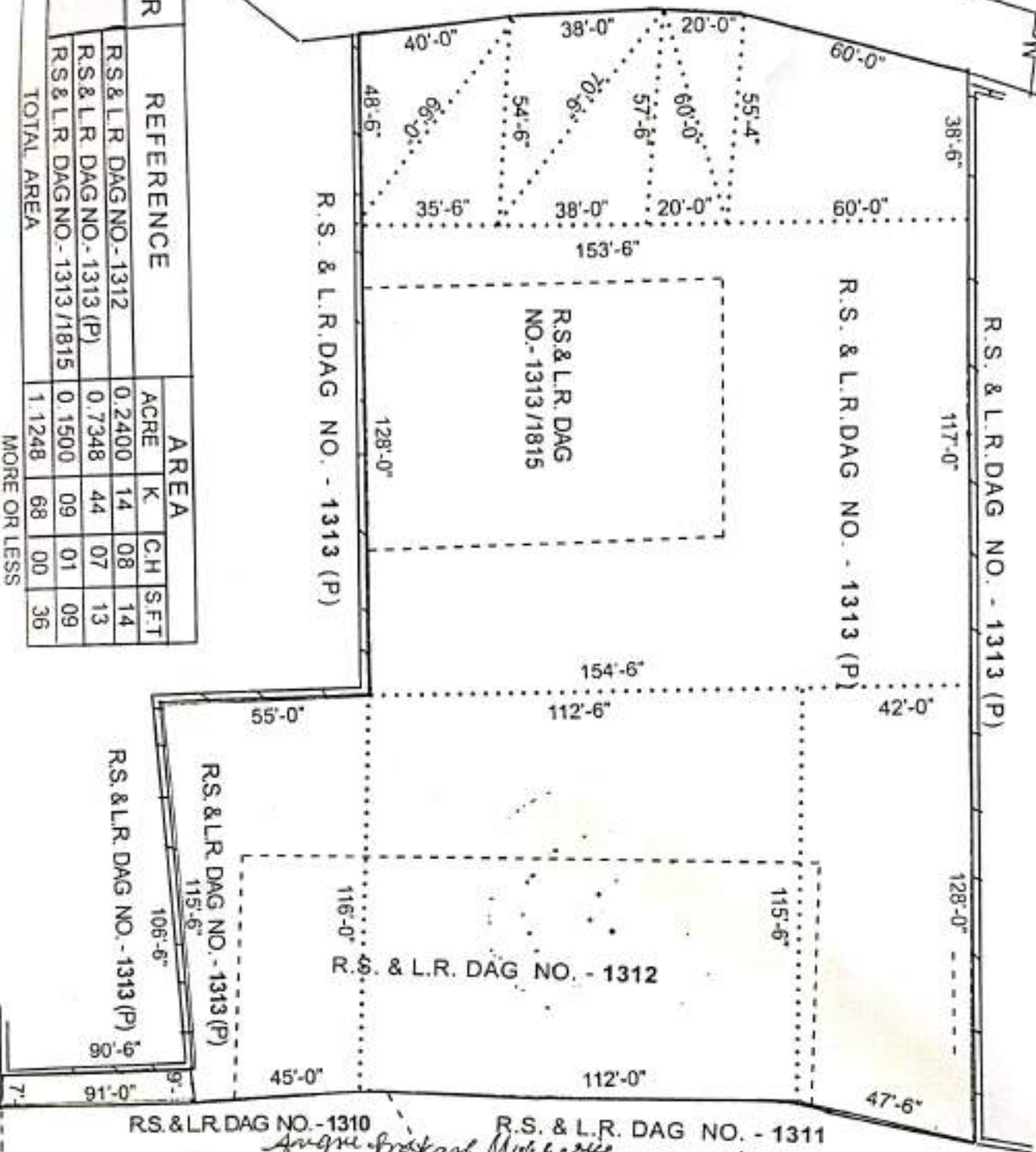

COLOUR	REFERENCE	AREA				
		ACRE	K	CH	SFT	
	R.S. & L.R. DAG NO. - 1312	0.2400	14	08	14	
	R.S. & L.R. DAG NO. - 1313 (P)	0.7348	44	07	13	
	R.S. & L.R. DAG NO. - 1313/1815	0.1500	09	01	09	
	TOTAL AREA	1.1248	68	00	36	

MORE OR LESS

SCALE - 1" = 40'-0"

RS. & L.R. DAG NO. - 1310

R.S. & L.R. DAG NO. - 1311

SIGNATURE OF OWNERS -

Prakash Mukherjee
Prabhat Kumar Mukherjee
Prabhat Mukherjee
Arati Mukherjee
Jaya Chatterjee
Beharish Banerjee
Dolly Mukherjee
Mallika Banerjee
Sankar Roy Chowdhury
Somen Roy Chowdhury
মৌসুমী রায় চৌধুরী

COPIED BY
 M. BISWAS
 SURVEYER
 RAJARHAT



Govt. of West Bengal
Directorate of Registration & Stamp
Revenue
GRIPS eChallan



192022230189985491

GRN Details

GRN:	192022230189985491	Payment Mode:	Online Payment
GRN Date:	25/11/2022 09:38:02	Bank/Gateway:	State Bank of India
BRN :	CKV4897025	BRN Date:	25/11/2022 09:39:30
GRIPS Payment ID:	251120222018998548	Payment Init. Date:	25/11/2022 09:38:02
Payment Status:	Successful	Payment Ref. No:	2003324002/3/2022

[Query No * Query Year]

Depositor Details

Depositor's Name:	ANGSU PRAKASH MUKHERJEE
Address:	RECKJOANI, RAJARHAT, NORTH 24 PGS., West Bengal, 700135
Mobile:	9830668849
Contact No:	9830668849
Depositor Status:	Buyer/Claimants
Query No:	2003324002
Applicant's Name:	Org MANDAL AND ASSOCIATE
Identification No:	2003324002/3/2022
Remarks:	Merger/Demerger, Amalgamation (Other than company amalgamation) Payment No 3
Period From (dd/mm/yyyy):	25/11/2022
Period To (dd/mm/yyyy):	25/11/2022

Payment Details

Sl. No.	Payment Ref No	Head of A/C Description	Head of A/C	Amount (₹)
1	2003324002/3/2022	Property Registration- Stamp duty	0030-02-103-003-02	298021
2	2003324002/3/2022	Property Registration- Registration Fees	0030-03-104-001-16	597015
			Total	895036

IN WORDS: EIGHT LAKH NINETY FIVE THOUSAND THIRTY SIX ONLY.

Major Information of the Deed

Deed No :	I-1523-20725/2022	Date of Registration	23/12/2022
Query No / Year	1523-2003324002/2022	Office where deed is registered	
Query Date	23/11/2022 1:21:26 PM	A.D.S.R. RAJARHAT, District: North 24-Parganas	
Applicant Name, Address & Other Details	MANDAL AND ASSOCIATE KANJIALPARA, Thana : Rajarhat, District : North 24-Parganas, WEST BENGAL, PIN - 700135, Mobile No : 9830668849, Status : Solicitor firm		
Transaction	Additional Transaction		
[1301] Merger/Demerger, Amalgamation (Other than company amalgamation)	[4305] Other than Immovable Property, Declaration [No of Declaration : 2]		
Set Forth value	Market Value		
Rs 27/-	Rs 5,97,00,121/-		
Stampduty Paid(SD)	Registration Fee Paid		
Rs 2,98,521/- (Article:23)	Rs. 5,97,015/- (Article:A(1). E)		
Remarks			

Land Details :

District: North 24-Parganas, P.S.- Rajarhat, Gram Panchayat: RAJARHAT BISHNUPUR-I, Mouza: Rekjoyani, JI No: 13 Pin Code : 700135

Sch No	Plot Number	Khatian Number	Land Proposed	Use ROR	Area of Land	SetForth Value (In Rs.)	Market Value (In Rs.)	Other Details
L1	LR-1313 (RS :-)	LR-9191	Bastu	Bastu	8 Dec	1/-	44,45,072/-	Width of Approach Road: 25 Ft., Adjacent to Metal Road,
L2	LR-1313 (RS :-)	LR-1980	Bastu	Bastu	8.7 Dec	1/-	48,34,016/-	Width of Approach Road: 25 Ft., Adjacent to Metal Road,
L3	LR-1313 (RS :-)	LR-7914	Bastu	Bastu	8.54 Dec	1/-	47,45,115/-	Width of Approach Road: 25 Ft., Adjacent to Metal Road,
L4	LR-1313 (RS :-)	LR-9190	Bastu	Bastu	8 Dec	1/-	44,45,072/-	Width of Approach Road: 25 Ft., Adjacent to Metal Road,
L5	LR-1313/1815 (RS :-)	LR-1980	Bastu	Bastu	5.625 Dec	1/-	31,25,441/-	Width of Approach Road: 25 Ft., Adjacent to Metal Road,
L6	LR-1313/1815 (RS :-)	LR-7914	Bastu	Bastu	1.875 Dec	1/-	10,41,814/-	Width of Approach Road: 25 Ft., Adjacent to Metal Road,
L7	LR-1312 (RS :-)	LR-1981	Bastu	Pukur	9 Dec	1/-	35,71,920/-	Width of Approach Road: 25 Ft., Adjacent to Metal Road,

	LR-1980	Bastu	Pukur	9 Dec	1/-	35,71,920/-	Width of Approach Road: 25 Ft., Adjacent to Metal Road.	
	LR-7914	Bastu	Pukur	3 Dec	1/-	11,90,641/-	Width of Approach Road: 25 Ft., Adjacent to Metal Road.	
L10	LR-1313 (RS :-)	LR-8178	Bastu	Bastu	2.14 Dec	1/-	11,89,057/-	Width of Approach Road: 25 Ft., Adjacent to Metal Road.
L11	LR-1313 (RS :-)	LR-8177	Bastu	Bastu	2.14 Dec	1/-	11,89,057/-	Width of Approach Road: 25 Ft., Adjacent to Metal Road.
L12	LR-1313 (RS :-)	LR-8179	Bastu	Bastu	2.14 Dec	1/-	11,89,057/-	Width of Approach Road: 25 Ft., Adjacent to Metal Road.
L13	LR-1313 (RS :-)	LR-8180	Bastu	Bastu	2.12 Dec	1/-	11,77,944/-	Width of Approach Road: 25 Ft., Adjacent to Metal Road.
L14	LR-1313/1815 (RS :-)	LR-8178	Bastu	Bastu	0.468 Dec	1/-	2,60,037/-	Width of Approach Road: 25 Ft., Adjacent to Metal Road.
L15	LR-1313/1815 (RS :-)	LR-8177	Bastu	Bastu	0.468 Dec	1/-	2,60,037/-	Width of Approach Road: 25 Ft., Adjacent to Metal Road.
L16	LR-1313/1815 (RS :-)	LR-8179	Bastu	Bastu	0.4695 Dec	1/-	2,60,870/-	Width of Approach Road: 25 Ft., Adjacent to Metal Road.
L17	LR-1313/1815 (RS :-)	LR-8180	Bastu	Bastu	0.4695 Dec	1/-	2,60,870/-	Width of Approach Road: 25 Ft., Adjacent to Metal Road.
L18	LR-1312 (RS :-)	LR-8178	Bastu	Pukur	0.7512 Dec	1/-	2,98,137/-	Width of Approach Road: 25 Ft., Adjacent to Metal Road.
L19	LR-1312 (RS :-)	LR-8177	Bastu	Pukur	0.7512 Dec	1/-	2,98,137/-	Width of Approach Road: 25 Ft., Adjacent to Metal Road.
L20	LR-1312 (RS :-)	LR-8179	Bastu	Pukur	0.7488 Dec	1/-	2,97,184/-	Width of Approach Road: 25 Ft., Adjacent to Metal Road.
L21	LR-1312 (RS :-)	LR-8180	Bastu	Pukur	0.7488 Dec	1/-	2,97,184/-	Width of Approach Road: 25 Ft., Adjacent to Metal Road.

	LR-9182	Bastu	Bastu	8 Dec	1/-	44,45,072/-	Width of Approach Road: 25 Ft., Adjacent to Metal Road.
	LR-9183	Bastu	Bastu	7.7 Dec	1/-	42,78,382/-	Width of Approach Road: 25 Ft., Adjacent to Metal Road.
L24	LR-9181	Bastu	Bastu	8 Dec	1/-	44,45,072/-	Width of Approach Road: 25 Ft., Adjacent to Metal Road.
L25	LR-9169	Bastu	Bastu	8 Dec	1/-	44,45,072/-	Width of Approach Road: 25 Ft., Adjacent to Metal Road.
L26	LR-9183	Bastu	Bastu	5.625 Dec	1/-	31,25,441/-	Width of Approach Road: 25 Ft., Adjacent to Metal Road.
	TOTAL :			112.48Dec	26 /-	586,87,621 /-	
	Grand Total :			112.48Dec	26 /-	586,87,621 /-	

Structure Details :

Sch No	Structure Details	Area of Structure	Setforth Value (In Rs.)	Market value (In Rs.)	Other Details
S1	On Land L1, L2, L3, L4, L5, L6, L10, L11, L12, L13, L14, L15, L16, L17, L22, L23, L24, L25, L26	1500 Sq Ft.	1/-	10,12,500/-	Structure Type: Structure
	Gr. Floor, Area of floor : 1500 Sq Ft., Residential Use, Cemented Floor, Age of Structure: 0Year, Roof Type: Pucca, Extent of Completion: Complete				
	Total :	1500 sq ft	1/-	10,12,500 /-	

Details :

Name, Address, Photo, Finger print and Signature

ANGSU PRAKASH MUKHERJEE

Son of Late RASHBEHARI MUKHERJEE RECKJOANI, City - Not Specified, P.O - RAJARHAT, P.S:-Rajarhat, District:-North 24-Parganas, West Bengal, India, PIN:- 700135 Sex: Male, By Caste: Hindu, Occupation: Retired Person, Citizen of: India, PAN No.: BFxxxxxx0D, Aadhaar No: 46xxxxxxxx0297, Status: Individual, Executed by: Self, Date of Execution: 25/11/2022
 , Admitted by: Self, Date of Admission: 25/11/2022 ,Place: Pvt. Residence, Executed by: Self, Date of Execution: 25/11/2022
 , Admitted by: Self, Date of Admission: 25/11/2022 ,Place: Pvt. Residence

2 PRABHAT KUMAR MUKHERJEE, (Alias: PRABHAT MUKHERJEE)

Son of Late RASHBEHARI MUKHERJEE RECKJOANI, City:- Not Specified, P.O:- RAJARHAT, P.S:-Rajarhat, District:-North 24-Parganas, West Bengal, India, PIN:- 700135 Sex: Male, By Caste: Hindu, Occupation: Business, Citizen of: India, PAN No.:: BFxxxxxx9N, Aadhaar No: 56xxxxxxxx0241, Status: Individual, Executed by: Self, Date of Execution: 25/11/2022
 , Admitted by: Self, Date of Admission: 25/11/2022 ,Place: Pvt. Residence, Executed by: Self, Date of Execution: 25/11/2022
 , Admitted by: Self, Date of Admission: 25/11/2022 ,Place: Pvt. Residence

3 ARATI MUKHERJEE

Daughter of Late RASHBEHARI MUKHERJEE RECKJOANI, City:- Not Specified, P.O:- RAJARHAT, P.S:-Rajarhat, District:-North 24-Parganas, West Bengal, India, PIN:- 700135 Sex: Female, By Caste: Hindu, Occupation: House wife, Citizen of: India, PAN No.:: CJxxxxxx7L, Aadhaar No: 76xxxxxxxx7115, Status: Individual, Executed by: Self, Date of Execution: 25/11/2022
 , Admitted by: Self, Date of Admission: 25/11/2022 ,Place: Pvt. Residence, Executed by: Self, Date of Execution: 25/11/2022
 , Admitted by: Self, Date of Admission: 25/11/2022 ,Place: Pvt. Residence

4 SAMIR ROY CHOWDHURY

Son of Late BIMAL ROY CHOWDHURY RECKJOANI, City:- Not Specified, P.O:- RAJARHAT, P.S:-Rajarhat, District:-North 24-Parganas, West Bengal, India, PIN:- 700135 Sex: Male, By Caste: Hindu, Occupation: Service, Citizen of: India, PAN No.:: BNxxxxxx7H, Aadhaar No: 42xxxxxxxx5818, Status: Individual, Executed by: Self, Date of Execution: 25/11/2022
 , Admitted by: Self, Date of Admission: 25/11/2022 ,Place: Pvt. Residence, Executed by: Self, Date of Execution: 25/11/2022
 , Admitted by: Self, Date of Admission: 25/11/2022 ,Place: Pvt. Residence

5 SOUMEN ROY CHOWDHURY

Son of SAMIR ROY CHOWDHURY RECKJOANI, City:- Not Specified, P.O:- RAJARHAT, P.S:-Rajarhat, District:-North 24-Parganas, West Bengal, India, PIN:- 700135 Sex: Male, By Caste: Hindu, Occupation: Student, Citizen of: India, PAN No.:: BBxxxxxx7P, Aadhaar No: 97xxxxxxxx7550, Status: Individual, Executed by: Self, Date of Execution: 25/11/2022
 , Admitted by: Self, Date of Admission: 25/11/2022 ,Place: Pvt. Residence, Executed by: Self, Date of Execution: 25/11/2022
 , Admitted by: Self, Date of Admission: 25/11/2022 ,Place: Pvt. Residence

6 MOUSUMI ROY CHOWDHURY

Wife of SAMIR ROY CHOWDHURY RECKJOANI, City:- Not Specified, P.O:- RAJARHAT, P.S:-Rajarhat, District:-North 24-Parganas, West Bengal, India, PIN:- 700135 Sex: Female, By Caste: Hindu, Occupation: House wife, Citizen of: India, PAN No.:: BJxxxxxx9D, Aadhaar No: 74xxxxxxxx1762, Status: Individual, Executed by: Self, Date of Execution: 25/11/2022
 , Admitted by: Self, Date of Admission: 25/11/2022 ,Place: Pvt. Residence, Executed by: Self, Date of Execution: 25/11/2022
 , Admitted by: Self, Date of Admission: 25/11/2022 ,Place: Pvt. Residence

JAYA CHATTERJEE

Wife of KRISHNA DAS CHATTERJEE SRI ARABINDA SARANI, City:- Not Specified, P.O:- HATKHOLA, P.S:- Shyampukur, District:-Kolkata, West Bengal, India, PIN:- 700005 Sex: Female, By Caste: Hindu, Occupation: House wife, Citizen of India, PAN No.:: ARxxxxxx8H, Aadhaar No: 51xxxxxxxx7886, Status :Individual, Executed by: Self, Date of Execution: 25/11/2022
 Admitted by: Self, Date of Admission: 25/11/2022 ,Place : Pvt. Residence, Executed by: Self, Date of Execution: 25/11/2022
 Admitted by: Self, Date of Admission: 25/11/2022 ,Place : Pvt. Residence

8 DEBASISH BANERJEE

Son of Late SAMBHU NATH BANERJEE RECKJOANI, City:- Not Specified, P.O:- RAJARHAT, P.S:-Rajarhat, District:-North 24-Parganas, West Bengal, India, PIN:- 700135 Sex: Male, By Caste: Hindu, Occupation: Business, Citizen of India, PAN No.:: BWxxxxxx8R, Aadhaar No: 36xxxxxxxx1033, Status :Individual, Executed by: Self, Date of Execution: 25/11/2022
 Admitted by: Self, Date of Admission: 25/11/2022 ,Place : Pvt. Residence, Executed by: Self, Date of Execution: 25/11/2022
 Admitted by: Self, Date of Admission: 25/11/2022 ,Place : Pvt. Residence

9 DOLLY MUKHERJEE

Wife of SUBHENDU MUKHERJEE RECKJOANI, City:- Not Specified, P.O:- RAJARHAT, P.S:-Rajarhat, District:-North 24-Parganas, West Bengal, India, PIN:- 700135 Sex: Female, By Caste: Hindu, Occupation: House wife, Citizen of India, PAN No.:: BXxxxxxx1J, Aadhaar No: 31xxxxxxxx8035, Status :Individual, Executed by: Self, Date of Execution: 25/11/2022
 Admitted by: Self, Date of Admission: 25/11/2022 ,Place : Pvt. Residence, Executed by: Self, Date of Execution: 25/11/2022
 Admitted by: Self, Date of Admission: 25/11/2022 ,Place : Pvt. Residence

10 MALLIKA BANERJEE

Daughter of Late SAMBHUNATH BANERJEE RECKJOANI, City:- Not Specified, P.O:- RAJARHAT, P.S:-Rajarhat, District:-North 24-Parganas, West Bengal, India, PIN:- 700135 Sex: Female, By Caste: Hindu, Occupation: House wife, Citizen of India, PAN No.:: DPxxxxxx1Q, Aadhaar No: 94xxxxxxxx5266, Status :Individual, Executed by: Self, Date of Execution: 25/11/2022
 Admitted by: Self, Date of Admission: 25/11/2022 ,Place : Pvt. Residence, Executed by: Self, Date of Execution: 25/11/2022
 Admitted by: Self, Date of Admission: 25/11/2022 ,Place : Pvt. Residence

Buyer Details :

Sl No	Name,Address,Photo,Finger print and Signature
1	ANGSU PRAKASH MUKHERJEE (Presentant) Son of Late RASHBEHARI MUKHERJEE RECKJOANI, City:- Not Specified, P.O:- RAJARHAT, P.S:-Rajarhat, District:-North 24-Parganas, West Bengal, India, PIN:- 700135 Sex: Male, By Caste: Hindu, Occupation: Retired Person, Citizen of India, PAN No.:: BFxxxxxx0D, Aadhaar No: 46xxxxxxxx0297, Status :Individual, Executed by: Self, Date of Execution: 25/11/2022 Admitted by: Self, Date of Admission: 25/11/2022 ,Place : Pvt. Residence
2	PRABHAT KUMAR MUKHERJEE, (Alias: PRABHAT MUKHERJEE) Son of Late RASHBEHARI MUKHREJEE RECKJOANI, City:- Not Specified, P.O:- RAJARHAT, P.S:-Rajarhat, District:-North 24-Parganas, West Bengal, India, PIN:- 700135 Sex: Male, By Caste: Hindu, Occupation: Business, Citizen of India, PAN No.:: BFxxxxxx9N, Aadhaar No: 56xxxxxxxx0241, Status :Individual, Executed by: Self, Date of Execution: 25/11/2022 Admitted by: Self, Date of Admission: 25/11/2022 ,Place : Pvt. Residence
3	ARATI MUKHERJEE Daughter of Late RASHBEHARI MUKHERJEE RECKJOANI, City:- Not Specified, P.O:- RAJARHAT, P.S:-Rajarhat, District:-North 24-Parganas, West Bengal, India, PIN:- 700135 Sex: Female, By Caste: Hindu, Occupation: House wife, Citizen of India, PAN No.:: CJxxxxxx7L, Aadhaar No: 76xxxxxxxx7115, Status :Individual, Executed by: Self, Date of Execution: 25/11/2022 Admitted by: Self, Date of Admission: 25/11/2022 ,Place : Pvt. Residence

SAMIR ROY CHOWDHURY

Son of Late BIMAL ROY CHOWDHURY RECKJOANI, City:- Not Specified, P.O:- RAJARHAT, P.S:-Rajarhat, District:-North 24-Parganas, West Bengal, India, PIN:- 700135 Sex: Male, By Caste: Hindu, Occupation: Service, Citizen of India, PAN No. : BNxxxxxx7H, Aadhaar No: 42xxxxxxxx5818, Status :Individual, Executed by: Self, Date of Execution: 25/11/2022
 Admitted by: Self, Date of Admission: 25/11/2022 ,Place : Pvt. Residence

SOUMEN ROY CHOWDHURY

Son of SAMIR ROY CHOWDHURY RECKJOANI, City:- Not Specified, P.O:- RAJARHAT, P.S:-Rajarhat, District:-North 24-Parganas, West Bengal, India, PIN:- 700135 Sex: Male, By Caste: Hindu, Occupation: Student, Citizen of India, PAN No. : BBxxxxxx7P, Aadhaar No: 97xxxxxxxx7550, Status :Individual, Executed by: Self, Date of Execution: 25/11/2022
 Admitted by: Self, Date of Admission: 25/11/2022 ,Place : Pvt. Residence

MOUSUMI ROY CHOWDHURY

Wife of SAMIR ROY CHOWDHURY RECKJOANI, City:- Not Specified, P.O:- RAJARHAT, P.S:-Rajarhat, District:-North 24-Parganas, West Bengal, India, PIN:- 700135 Sex: Female, By Caste: Hindu, Occupation: House wife, Citizen of India, PAN No. : BJxxxxxx9D, Aadhaar No: 74xxxxxxxx1762, Status :Individual, Executed by: Self, Date of Execution: 25/11/2022
 Admitted by: Self, Date of Admission: 25/11/2022 ,Place : Pvt. Residence

JAYA CHATTERJEE

Wife of KRISHNA DAS CHATTERJEE SHRI ARABINDA SARANI, City:- Not Specified, P.O:- HATKHOLA, P.S:-Shyampukur, District:-Kolkata, West Bengal, India, PIN:- 700005 Sex: Female, By Caste: Hindu, Occupation: House wife, Citizen of India, PAN No. : ARxxxxxx8H, Aadhaar No: 51xxxxxxxx7886, Status :Individual, Executed by: Self, Date of Execution: 25/11/2022
 Admitted by: Self, Date of Admission: 25/11/2022 ,Place : Pvt. Residence

DEBASISH BANERJEE

Son of Late SAMBHU NATH BANERJEE RECKJOANI, City:- Not Specified, P.O:- RAJARHAT, P.S:-Rajarhat, District:-North 24-Parganas, West Bengal, India, PIN:- 700135 Sex: Male, By Caste: Hindu, Occupation: Business, Citizen of India, PAN No. : BWxxxxxx8R, Aadhaar No: 36xxxxxxxx1033, Status :Individual, Executed by: Self, Date of Execution: 25/11/2022
 Admitted by: Self, Date of Admission: 25/11/2022 ,Place : Pvt. Residence

DOLLY MUKHERJEE

Wife of SUBHENDU MUKHERJEE RECKJOANI, City:- Not Specified, P.O:- RAJARHAT, P.S:-Rajarhat, District:-North 24-Parganas, West Bengal, India, PIN:- 700135 Sex: Female, By Caste: Hindu, Occupation: House wife, Citizen of India, PAN No. : BXxxxxxx1J, Aadhaar No: 31xxxxxxxx8035, Status :Individual, Executed by: Self, Date of Execution: 25/11/2022
 Admitted by: Self, Date of Admission: 25/11/2022 ,Place : Pvt. Residence

MALLIKA BANERJEE

Daughter of Late SAMBHUNATH BANERJEE RECKJOANI, City:- Not Specified, P.O:- RAJARHAT, P.S:-Rajarhat, District:-North 24-Parganas, West Bengal, India, PIN:- 700135 Sex: Female, By Caste: Hindu, Occupation: House wife, Citizen of India, PAN No. : DPxxxxxx1Q, Aadhaar No: 94xxxxxxxx5266, Status :Individual, Executed by: Self, Date of Execution: 25/11/2022
 Admitted by: Self, Date of Admission: 25/11/2022 ,Place : Pvt. Residence

Identifier Details :

Name	Photo	Finger Print	Signature
PRANAB KUMAR RAYCHAUDHURI Son of Late NANU RAYCHAUDHURI RECKJOANI, City:- Not Specified, P.O:- RAJARHAT, P.S:-Rajarhat, District:-North 24-Parganas, West Bengal, India, PIN:- 700135			

Identifier Of ANGSU PRAKASH MUKHERJEE, PRABHAT KUMAR MUKHERJEE, ARATI MUKHERJEE, SAMIR ROY CHOWDHURY, SOUMEN ROY CHOWDHURY, MOUSUMI ROY CHOWDHURY, JAYA CHATTERJEE, DEBASISH BANERJEE, DOLLY MUKHERJEE, MALLIKA BANERJEE, ANGSU PRAKASH MUKHERJEE, PRABHAT KUMAR MUKHERJEE, ARATI MUKHERJEE, SAMIR ROY CHOWDHURY, SOUMEN ROY CHOWDHURY, MOUSUMI ROY CHOWDHURY, JAYA CHATTERJEE, DEBASISH BANERJEE, DOLLY MUKHERJEE, MALLIKA BANERJEE

Transfer of property for L1

Sl.No	From	To. with area (Name-Area)
	ANGSU PRAKASH MUKHERJEE	PRABHAT KUMAR MUKHERJEE-1.6 Dec, ARATI MUKHERJEE-0.8 Dec, SAMIR ROY CHOWDHURY-0.8 Dec, SOUMEN ROY CHOWDHURY-0.8 Dec, MOUSUMI ROY CHOWDHURY-0.8 Dec, JAYA CHATTERJEE-0.8 Dec, DEBASISH BANERJEE-0.8 Dec, DOLLY MUKHERJEE-0.8 Dec, MALLIKA BANERJEE-0.8 Dec

Transfer of property for L10

Sl.No	From	To. with area (Name-Area)
1	JAYA CHATTERJEE	ANGSU PRAKASH MUKHERJEE-0.214 Dec, PRABHAT KUMAR MUKHERJEE-0.428 Dec, ARATI MUKHERJEE-0.214 Dec, SAMIR ROY CHOWDHURY-0.214 Dec, SOUMEN ROY CHOWDHURY-0.214 Dec, MOUSUMI ROY CHOWDHURY-0.214 Dec, DEBASISH BANERJEE-0.214 Dec, DOLLY MUKHERJEE-0.214 Dec, MALLIKA BANERJEE-0.214 Dec

Transfer of property for L11

Sl.No	From	To. with area (Name-Area)
1	DEBASISH BANERJEE	ANGSU PRAKASH MUKHERJEE-0.214 Dec, PRABHAT KUMAR MUKHERJEE-0.428 Dec, ARATI MUKHERJEE-0.214 Dec, SAMIR ROY CHOWDHURY-0.214 Dec, SOUMEN ROY CHOWDHURY-0.214 Dec, MOUSUMI ROY CHOWDHURY-0.214 Dec, JAYA CHATTERJEE-0.214 Dec, DOLLY MUKHERJEE-0.214 Dec, MALLIKA BANERJEE-0.214 Dec

Transfer of property for L12

Sl.No	From	To. with area (Name-Area)
1	DOLLY MUKHERJEE	ANGSU PRAKASH MUKHERJEE-0.214 Dec, PRABHAT KUMAR MUKHERJEE-0.428 Dec, ARATI MUKHERJEE-0.214 Dec, SAMIR ROY CHOWDHURY-0.214 Dec, SOUMEN ROY CHOWDHURY-0.214 Dec, MOUSUMI ROY CHOWDHURY-0.214 Dec, JAYA CHATTERJEE-0.214 Dec, DEBASISH BANERJEE-0.214 Dec, MALLIKA BANERJEE-0.214 Dec

Transfer of property for L13

Sl.No	From	To. with area (Name-Area)
1	MALLIKA BANERJEE	ANGSU PRAKASH MUKHERJEE-0.212 Dec, PRABHAT KUMAR MUKHERJEE-0.424 Dec, ARATI MUKHERJEE-0.212 Dec, SAMIR ROY CHOWDHURY-0.212 Dec, SOUMEN ROY CHOWDHURY-0.212 Dec, MOUSUMI ROY CHOWDHURY-0.212 Dec, JAYA CHATTERJEE-0.212 Dec, DEBASISH BANERJEE-0.212 Dec, DOLLY MUKHERJEE-0.212 Dec

Transfer of property for L14

Sl.No	From	To. with area (Name-Area)
1	JAYA CHATTERJEE	ANGSU PRAKASH MUKHERJEE-0.0468 Dec, PRABHAT KUMAR MUKHERJEE-0.0936 Dec, ARATI MUKHERJEE-0.0468 Dec, SAMIR ROY CHOWDHURY-0.0468 Dec, SOUMEN ROY CHOWDHURY-0.0468 Dec, MOUSUMI ROY CHOWDHURY-0.0468 Dec, DEBASISH BANERJEE-0.0468 Dec, DOLLY MUKHERJEE-0.0468 Dec, MALLIKA BANERJEE-0.0468 Dec

Transfer of property for L15

Sl.No	From	To. with area (Name-Area)
1	DEBASISH BANERJEE	ANGSU PRAKASH MUKHERJEE-0.0468 Dec, PRABHAT KUMAR MUKHERJEE-0.0936 Dec, ARATI MUKHERJEE-0.0468 Dec, SAMIR ROY CHOWDHURY-0.0468 Dec, SOUMEN ROY CHOWDHURY-0.0468 Dec, MOUSUMI ROY CHOWDHURY-0.0468 Dec, JAYA CHATTERJEE-0.0468 Dec, DOLLY MUKHERJEE-0.0468 Dec, MALLIKA BANERJEE-0.0468 Dec

Transfer of property for L16		
From	To. with area (Name-Area)	
DOLLY MUKHERJEE	ANGSU PRAKASH MUKHERJEE-0.04695 Dec, PRABHAT KUMAR MUKHERJEE-0.0939 Dec, ARATI MUKHERJEE-0.04695 Dec, SAMIR ROY CHOWDHURY-0.04695 Dec, SOUMEN ROY CHOWDHURY-0.04695 Dec, MOUSUMI ROY CHOWDHURY-0.04695 Dec, JAYA CHATTERJEE-0.04695 Dec, DEBASISH BANERJEE-0.04695 Dec, MALLIKA BANERJEE-0.04695 Dec	
Transfer of property for L17		
Sl.No	From	To. with area (Name-Area)
1	MALLIKA BANERJEE	ANGSU PRAKASH MUKHERJEE-0.04695 Dec, PRABHAT KUMAR MUKHERJEE-0.0939 Dec, ARATI MUKHERJEE-0.04695 Dec, SAMIR ROY CHOWDHURY-0.04695 Dec, SOUMEN ROY CHOWDHURY-0.04695 Dec, MOUSUMI ROY CHOWDHURY-0.04695 Dec, JAYA CHATTERJEE-0.04695 Dec, DEBASISH BANERJEE-0.04695 Dec, DOLLY MUKHERJEE-0.04695 Dec
Transfer of property for L18		
Sl.No	From	To. with area (Name-Area)
1	JAYA CHATTERJEE	ANGSU PRAKASH MUKHERJEE-0.07512 Dec, PRABHAT KUMAR MUKHERJEE-0.15024 Dec, ARATI MUKHERJEE-0.07512 Dec, SAMIR ROY CHOWDHURY-0.07512 Dec, SOUMEN ROY CHOWDHURY-0.07512 Dec, MOUSUMI ROY CHOWDHURY-0.07512 Dec, DEBASISH BANERJEE-0.07512 Dec, DOLLY MUKHERJEE-0.07512 Dec, MALLIKA BANERJEE-0.07512 Dec
Transfer of property for L19		
Sl.No	From	To. with area (Name-Area)
1	DEBASISH BANERJEE	ANGSU PRAKASH MUKHERJEE-0.07512 Dec, PRABHAT KUMAR MUKHERJEE-0.15024 Dec, ARATI MUKHERJEE-0.07512 Dec, SAMIR ROY CHOWDHURY-0.07512 Dec, SOUMEN ROY CHOWDHURY-0.07512 Dec, MOUSUMI ROY CHOWDHURY-0.07512 Dec, JAYA CHATTERJEE-0.07512 Dec, DOLLY MUKHERJEE-0.07512 Dec, MALLIKA BANERJEE-0.07512 Dec
Transfer of property for L2		
Sl.No	From	To. with area (Name-Area)
1	PRABHAT KUMAR MUKHERJEE	ANGSU PRAKASH MUKHERJEE-1.74 Dec, ARATI MUKHERJEE-0.87 Dec, SAMIR ROY CHOWDHURY-0.87 Dec, SOUMEN ROY CHOWDHURY-0.87 Dec, MOUSUMI ROY CHOWDHURY-0.87 Dec, JAYA CHATTERJEE-0.87 Dec, DEBASISH BANERJEE-0.87 Dec, DOLLY MUKHERJEE-0.87 Dec, MALLIKA BANERJEE-0.87 Dec
Transfer of property for L20		
Sl.No	From	To. with area (Name-Area)
1	DOLLY MUKHERJEE	ANGSU PRAKASH MUKHERJEE-0.07488 Dec, PRABHAT KUMAR MUKHERJEE-0.14976 Dec, ARATI MUKHERJEE-0.07488 Dec, SAMIR ROY CHOWDHURY-0.07488 Dec, SOUMEN ROY CHOWDHURY-0.07488 Dec, MOUSUMI ROY CHOWDHURY-0.07488 Dec, JAYA CHATTERJEE-0.07488 Dec, DEBASISH BANERJEE-0.07488 Dec, MALLIKA BANERJEE-0.07488 Dec
Transfer of property for L21		
Sl.No	From	To. with area (Name-Area)
1	MALLIKA BANERJEE	ANGSU PRAKASH MUKHERJEE-0.07488 Dec, PRABHAT KUMAR MUKHERJEE-0.14976 Dec, ARATI MUKHERJEE-0.07488 Dec, SAMIR ROY CHOWDHURY-0.07488 Dec, SOUMEN ROY CHOWDHURY-0.07488 Dec, MOUSUMI ROY CHOWDHURY-0.07488 Dec, JAYA CHATTERJEE-0.07488 Dec, DEBASISH BANERJEE-0.07488 Dec, DOLLY MUKHERJEE-0.07488 Dec

Transfer of property for L22

From	To. with area (Name-Area)
SAMIR ROY CHOWDHURY	ANGSU PRAKASH MUKHERJEE-0.8 Dec, PRABHAT KUMAR MUKHERJEE-1.6 Dec, ARATI MUKHERJEE-0.8 Dec, SOUMEN ROY CHOWDHURY-0.8 Dec, MOUSUMI ROY CHOWDHURY-0.8 Dec, JAYA CHATTERJEE-0.8 Dec, DEBASISH BANERJEE-0.8 Dec, DOLLY MUKHERJEE-0.8 Dec, MALLIKA BANERJEE-0.8 Dec

Transfer of property for L23

Sl.No	From	To. with area (Name-Area)
1	SAMIR ROY CHOWDHURY	ANGSU PRAKASH MUKHERJEE-0.77 Dec, PRABHAT KUMAR MUKHERJEE-1.54 Dec, ARATI MUKHERJEE-0.77 Dec, SOUMEN ROY CHOWDHURY-0.77 Dec, MOUSUMI ROY CHOWDHURY-0.77 Dec, JAYA CHATTERJEE-0.77 Dec, DEBASISH BANERJEE-0.77 Dec, DOLLY MUKHERJEE-0.77 Dec, MALLIKA BANERJEE-0.77 Dec

Transfer of property for L24

Sl.No	From	To. with area (Name-Area)
1	SOUMEN ROY CHOWDHURY	ANGSU PRAKASH MUKHERJEE-0.8 Dec, PRABHAT KUMAR MUKHERJEE-1.6 Dec, ARATI MUKHERJEE-0.8 Dec, SAMIR ROY CHOWDHURY-0.8 Dec, MOUSUMI ROY CHOWDHURY-0.8 Dec, JAYA CHATTERJEE-0.8 Dec, DEBASISH BANERJEE-0.8 Dec, DOLLY MUKHERJEE-0.8 Dec, MALLIKA BANERJEE-0.8 Dec

Transfer of property for L25

Sl.No	From	To. with area (Name-Area)
1	MOUSUMI ROY CHOWDHURY	ANGSU PRAKASH MUKHERJEE-0.8 Dec, PRABHAT KUMAR MUKHERJEE-1.6 Dec, ARATI MUKHERJEE-0.8 Dec, SAMIR ROY CHOWDHURY-0.8 Dec, SOUMEN ROY CHOWDHURY-0.8 Dec, JAYA CHATTERJEE-0.8 Dec, DEBASISH BANERJEE-0.8 Dec, DOLLY MUKHERJEE-0.8 Dec, MALLIKA BANERJEE-0.8 Dec

Transfer of property for L26

Sl.No	From	To. with area (Name-Area)
1	SAMIR ROY CHOWDHURY	ANGSU PRAKASH MUKHERJEE-0.5625 Dec, PRABHAT KUMAR MUKHERJEE-1.125 Dec, ARATI MUKHERJEE-0.5625 Dec, SOUMEN ROY CHOWDHURY-0.5625 Dec, MOUSUMI ROY CHOWDHURY-0.5625 Dec, JAYA CHATTERJEE-0.5625 Dec, DEBASISH BANERJEE-0.5625 Dec, DOLLY MUKHERJEE-0.5625 Dec, MALLIKA BANERJEE-0.5625 Dec

Transfer of property for L3

Sl.No	From	To. with area (Name-Area)
1	ARATI MUKHERJEE	ANGSU PRAKASH MUKHERJEE-0.854 Dec, PRABHAT KUMAR MUKHERJEE-1.708 Dec, SAMIR ROY CHOWDHURY-0.854 Dec, SOUMEN ROY CHOWDHURY-0.854 Dec, MOUSUMI ROY CHOWDHURY-0.854 Dec, JAYA CHATTERJEE-0.854 Dec, DEBASISH BANERJEE-0.854 Dec, DOLLY MUKHERJEE-0.854 Dec, MALLIKA BANERJEE-0.854 Dec

Transfer of property for L4

Sl.No	From	To. with area (Name-Area)
1	ARATI MUKHERJEE	ANGSU PRAKASH MUKHERJEE-0.8 Dec, PRABHAT KUMAR MUKHERJEE-1.6 Dec, SAMIR ROY CHOWDHURY-0.8 Dec, SOUMEN ROY CHOWDHURY-0.8 Dec, MOUSUMI ROY CHOWDHURY-0.8 Dec, JAYA CHATTERJEE-0.8 Dec, DEBASISH BANERJEE-0.8 Dec, DOLLY MUKHERJEE-0.8 Dec, MALLIKA BANERJEE-0.8 Dec

Transfer of property for L5

From	To. with area (Name-Area)
PRABHAT KUMAR MUKHERJEE	ANGSU PRAKASH MUKHERJEE-1.125 Dec,ARATI MUKHERJEE-0.5625 Dec,SAMIR ROY CHOWDHURY-0.5625 Dec,SOUMEN ROY CHOWDHURY-0.5625 Dec,MOUSUMI ROY CHOWDHURY-0.5625 Dec,JAYA CHATTERJEE-0.5625 Dec,DEBASISH BANERJEE-0.5625 Dec,DOLLY MUKHERJEE-0.5625 Dec,MALLIKA BANERJEE-0.5625 Dec

Transfer of property for L6

Sl.No	From	To. with area (Name-Area)
1	ARATI MUKHERJEE	ANGSU PRAKASH MUKHERJEE-0.1875 Dec,PRABHAT KUMAR MUKHERJEE-0.375 Dec,SAMIR ROY CHOWDHURY-0.1875 Dec,SOUMEN ROY CHOWDHURY-0.1875 Dec,MOUSUMI ROY CHOWDHURY-0.1875 Dec,JAYA CHATTERJEE-0.1875 Dec,DEBASISH BANERJEE-0.1875 Dec,DOLLY MUKHERJEE-0.1875 Dec,MALLIKA BANERJEE-0.1875 Dec

Transfer of property for L7

Sl.No	From	To. with area (Name-Area)
1	ANGSU PRAKASH MUKHERJEE	PRABHAT KUMAR MUKHERJEE-1.8 Dec,ARATI MUKHERJEE-0.9 Dec,SAMIR ROY CHOWDHURY-0.9 Dec,SOUMEN ROY CHOWDHURY-0.9 Dec,MOUSUMI ROY CHOWDHURY-0.9 Dec,JAYA CHATTERJEE-0.9 Dec,DEBASISH BANERJEE-0.9 Dec,DOLLY MUKHERJEE-0.9 Dec,MALLIKA BANERJEE-0.9 Dec

Transfer of property for L8

Sl.No	From	To. with area (Name-Area)
1	PRABHAT KUMAR MUKHERJEE	ANGSU PRAKASH MUKHERJEE-1.8 Dec,ARATI MUKHERJEE-0.9 Dec,SAMIR ROY CHOWDHURY-0.9 Dec,SOUMEN ROY CHOWDHURY-0.9 Dec,MOUSUMI ROY CHOWDHURY-0.9 Dec,JAYA CHATTERJEE-0.9 Dec,DEBASISH BANERJEE-0.9 Dec,DOLLY MUKHERJEE-0.9 Dec,MALLIKA BANERJEE-0.9 Dec

Transfer of property for L9

Sl.No	From	To. with area (Name-Area)
1	ARATI MUKHERJEE	ANGSU PRAKASH MUKHERJEE-0.3 Dec,PRABHAT KUMAR MUKHERJEE-0.6 Dec,SAMIR ROY CHOWDHURY-0.3 Dec,SOUMEN ROY CHOWDHURY-0.3 Dec,MOUSUMI ROY CHOWDHURY-0.3 Dec,JAYA CHATTERJEE-0.3 Dec,DEBASISH BANERJEE-0.3 Dec,DOLLY MUKHERJEE-0.3 Dec,MALLIKA BANERJEE-0.3 Dec

Transfer of property for S1

Sl.No	From	To. with area (Name-Area)
1	ANGSU PRAKASH MUKHERJEE	ANGSU PRAKASH MUKHERJEE-15.00000000 Sq Ft,PRABHAT KUMAR MUKHERJEE-15.00000000 Sq Ft,ARATI MUKHERJEE-15.00000000 Sq Ft,SAMIR ROY CHOWDHURY-15.00000000 Sq Ft,SOUMEN ROY CHOWDHURY-15.00000000 Sq Ft,MOUSUMI ROY CHOWDHURY-15.00000000 Sq Ft,JAYA CHATTERJEE-15.00000000 Sq Ft,DEBASISH BANERJEE-15.00000000 Sq Ft,DOLLY MUKHERJEE-15.00000000 Sq Ft,MALLIKA BANERJEE-15.00000000 Sq Ft
2	PRABHAT KUMAR MUKHERJEE	ANGSU PRAKASH MUKHERJEE-15.00000000 Sq Ft,PRABHAT KUMAR MUKHERJEE-15.00000000 Sq Ft,ARATI MUKHERJEE-15.00000000 Sq Ft,SAMIR ROY CHOWDHURY-15.00000000 Sq Ft,SOUMEN ROY CHOWDHURY-15.00000000 Sq Ft,MOUSUMI ROY CHOWDHURY-15.00000000 Sq Ft,JAYA CHATTERJEE-15.00000000 Sq Ft,DEBASISH BANERJEE-15.00000000 Sq Ft,DOLLY MUKHERJEE-15.00000000 Sq Ft,MALLIKA BANERJEE-15.00000000 Sq Ft

	ARATI MUKHERJEE	ANGSU PRAKASH MUKHERJEE-15.00000000 Sq Ft, PRABHAT KUMAR MUKHERJEE-15.00000000 Sq Ft, ARATI MUKHERJEE-15.00000000 Sq Ft, SAMIR ROY CHOWDHURY-15.00000000 Sq Ft, SOUMEN ROY CHOWDHURY-15.00000000 Sq Ft, MOUSUMI ROY CHOWDHURY-15.00000000 Sq Ft, JAYA CHATTERJEE-15.00000000 Sq Ft, DEBASISH BANERJEE-15.00000000 Sq Ft, DOLLY MUKHERJEE-15.00000000 Sq Ft, MALLIKA BANERJEE-15.00000000 Sq Ft
	SAMIR ROY CHOWDHURY	ANGSU PRAKASH MUKHERJEE-15.00000000 Sq Ft, PRABHAT KUMAR MUKHERJEE-15.00000000 Sq Ft, ARATI MUKHERJEE-15.00000000 Sq Ft, SAMIR ROY CHOWDHURY-15.00000000 Sq Ft, SOUMEN ROY CHOWDHURY-15.00000000 Sq Ft, MOUSUMI ROY CHOWDHURY-15.00000000 Sq Ft, JAYA CHATTERJEE-15.00000000 Sq Ft, DEBASISH BANERJEE-15.00000000 Sq Ft, DOLLY MUKHERJEE-15.00000000 Sq Ft, MALLIKA BANERJEE-15.00000000 Sq Ft
5	SOUMEN ROY CHOWDHURY	ANGSU PRAKASH MUKHERJEE-15.00000000 Sq Ft, PRABHAT KUMAR MUKHERJEE-15.00000000 Sq Ft, ARATI MUKHERJEE-15.00000000 Sq Ft, SAMIR ROY CHOWDHURY-15.00000000 Sq Ft, SOUMEN ROY CHOWDHURY-15.00000000 Sq Ft, MOUSUMI ROY CHOWDHURY-15.00000000 Sq Ft, JAYA CHATTERJEE-15.00000000 Sq Ft, DEBASISH BANERJEE-15.00000000 Sq Ft, DOLLY MUKHERJEE-15.00000000 Sq Ft, MALLIKA BANERJEE-15.00000000 Sq Ft
6	MOUSUMI ROY CHOWDHURY	ANGSU PRAKASH MUKHERJEE-15.00000000 Sq Ft, PRABHAT KUMAR MUKHERJEE-15.00000000 Sq Ft, ARATI MUKHERJEE-15.00000000 Sq Ft, SAMIR ROY CHOWDHURY-15.00000000 Sq Ft, SOUMEN ROY CHOWDHURY-15.00000000 Sq Ft, JAYA CHATTERJEE-15.00000000 Sq Ft, DEBASISH BANERJEE-15.00000000 Sq Ft, DOLLY MUKHERJEE-15.00000000 Sq Ft, MALLIKA BANERJEE-15.00000000 Sq Ft
7	JAYA CHATTERJEE	ANGSU PRAKASH MUKHERJEE-15.00000000 Sq Ft, PRABHAT KUMAR MUKHERJEE-15.00000000 Sq Ft, ARATI MUKHERJEE-15.00000000 Sq Ft, SAMIR ROY CHOWDHURY-15.00000000 Sq Ft, SOUMEN ROY CHOWDHURY-15.00000000 Sq Ft, JAYA CHATTERJEE-15.00000000 Sq Ft, DEBASISH BANERJEE-15.00000000 Sq Ft, DOLLY MUKHERJEE-15.00000000 Sq Ft, MALLIKA BANERJEE-15.00000000 Sq Ft
8	DEBASISH BANERJEE	ANGSU PRAKASH MUKHERJEE-15.00000000 Sq Ft, PRABHAT KUMAR MUKHERJEE-15.00000000 Sq Ft, ARATI MUKHERJEE-15.00000000 Sq Ft, SAMIR ROY CHOWDHURY-15.00000000 Sq Ft, SOUMEN ROY CHOWDHURY-15.00000000 Sq Ft, JAYA CHATTERJEE-15.00000000 Sq Ft, DEBASISH BANERJEE-15.00000000 Sq Ft, DOLLY MUKHERJEE-15.00000000 Sq Ft, MALLIKA BANERJEE-15.00000000 Sq Ft
9	DOLLY MUKHERJEE	ANGSU PRAKASH MUKHERJEE-15.00000000 Sq Ft, PRABHAT KUMAR MUKHERJEE-15.00000000 Sq Ft, ARATI MUKHERJEE-15.00000000 Sq Ft, SAMIR ROY CHOWDHURY-15.00000000 Sq Ft, SOUMEN ROY CHOWDHURY-15.00000000 Sq Ft, JAYA CHATTERJEE-15.00000000 Sq Ft, DEBASISH BANERJEE-15.00000000 Sq Ft, DOLLY MUKHERJEE-15.00000000 Sq Ft, MALLIKA BANERJEE-15.00000000 Sq Ft
10	MALLIKA BANERJEE	ANGSU PRAKASH MUKHERJEE-15.00000000 Sq Ft, PRABHAT KUMAR MUKHERJEE-15.00000000 Sq Ft, ARATI MUKHERJEE-15.00000000 Sq Ft, SAMIR ROY CHOWDHURY-15.00000000 Sq Ft, SOUMEN ROY CHOWDHURY-15.00000000 Sq Ft, JAYA CHATTERJEE-15.00000000 Sq Ft, DEBASISH BANERJEE-15.00000000 Sq Ft, DOLLY MUKHERJEE-15.00000000 Sq Ft, MALLIKA BANERJEE-15.00000000 Sq Ft

Details as per Land Record

North 24-Parganas, P. S:- Rajarhat, Gram Panchayat: RAJARHAT BISHNUPUR-I, Mouza: Rekjoyani, JI No: Code : 700135

Plot & Khatian Number	Details Of Land	Owner name in English as selected by Applicant
L1 LR Plot No:- 1313, LR Khatian No:- 9191	Owner: অংশুপ্রকাশ মুখার্জী, Gurdian: রাস বিহারী মুখার্জী, Address: নিজ, Classification: বাগান, Area: 0.08000000 Acre.	ANGSU PRAKASH MUKHERJEE
L2 LR Plot No:- 1313, LR Khatian No:- 1980	Owner: প্রভাত মুখার্জী, Gurdian: রাসবিহারী, Address: রেকজোয়ানী, Classification: বাগান, Area: 0.09000000 Acre.	PRABHAT KUMAR MUKHERJEE
L3 LR Plot No:- 1313, LR Khatian No:- 7914	Owner: আরতী মুখার্জী, Gurdian: রাসবিহারী মুখার্জী (মৃত), Address: রেকজোয়ানী, Classification: বাগান, Area: 0.09000000 Acre.	ARATI MUKHERJEE
L4 LR Plot No:- 1313, LR Khatian No:- 9190	Owner: আরতী মুখার্জী, Gurdian: রাস বিহারী মুখার্জী, Address: নিজ, Classification: বাগান, Area: 0.08000000 Acre.	ARATI MUKHERJEE
L5 LR Plot No:- 1313/1815, LR Khatian No:- 1980	Owner: প্রভাত মুখার্জী, Gurdian: রাসবিহারী, Address: রেকজোয়ানী, Classification: বাগ, Area: 0.05000000 Acre.	PRABHAT KUMAR MUKHERJEE
L6 LR Plot No:- 1313/1815, LR Khatian No:- 7914	Owner: আরতী মুখার্জী, Gurdian: রাসবিহারী মুখার্জী (মৃত), Address: রেকজোয়ানী, Classification: বাগ, Area: 0.02000000 Acre.	ARATI MUKHERJEE
L7 LR Plot No:- 1312, LR Khatian No:- 1981	Owner: অংশুপ্রকাশ মুখার্জী, Gurdian: রাস বিহারী, Address: রেকজোয়ানী, Classification: পুকুর, Area: 0.10000000 Acre.	ANGSU PRAKASH MUKHERJEE
L8 LR Plot No:- 1312, LR Khatian No:- 1980	Owner: প্রভাত মুখার্জী, Gurdian: রাসবিহারী, Address: রেকজোয়ানী, Classification: পুকুর, Area: 0.09000000 Acre.	PRABHAT KUMAR MUKHERJEE
L9 LR Plot No:- 1312, LR Khatian No:- 7914	Owner: আরতী মুখার্জী, Gurdian: রাসবিহারী মুখার্জী (মৃত), Address: রেকজোয়ানী, Classification: পুকুর, Area: 0.02000000 Acre.	ARATI MUKHERJEE

	LR Plot No:- 1313, LR Khatian No:- 8178	Owner: জয়া চ্যাটার্জী, Gurdian: কৃষ্ণদাস চ্যাটার্জী, Address: নিজ , Classification: বাগান, Area: 0.02000000 Acre,	JAYA CHATTERJEE
	LR Plot No:- 1313, LR Khatian No:- 8177	Owner: দেবশীষ ব্যানার্জী, Gurdian: মৃত শমুনাথ, Address: নিজ , Classification: বাগান, Area: 0.03000000 Acre,	DEBASISH BANERJEE
L12	LR Plot No:- 1313, LR Khatian No:- 8179	Owner: ডলি মুখার্জী, Gurdian: সুহেলু , Address: নিজ , Classification: বাগান, Area: 0.02000000 Acre,	DOLLY MUKHERJEE
L13	LR Plot No:- 1313, LR Khatian No:- 8180	Owner: মল্লিকা ব্যানার্জী, Gurdian: মৃত শমুনাথ, Address: নিজ , Classification: বাগান, Area: 0.02000000 Acre,	MALLIKA BANERJEE
L14	LR Plot No:- 1313/1815, LR Khatian No:- 8178	Owner: জয়া চ্যাটার্জী, Gurdian: কৃষ্ণদাস চ্যাটার্জী, Address: নিজ , Classification: বাস, Area: 0.01000000 Acre,	JAYA CHATTERJEE
L15	LR Plot No:- 1313/1815, LR Khatian No:- 8177	Owner: দেবশীষ ব্যানার্জী, Gurdian: মৃত শমুনাথ, Address: নিজ , Classification: বাস, Area: 0.01000000 Acre,	DEBASISH BANERJEE
L16	LR Plot No:- 1313/1815, LR Khatian No:- 8179	Owner: ডলি মুখার্জী, Gurdian: সুহেলু , Address: নিজ , Classification: বাস, Area: 0.01000000 Acre,	DOLLY MUKHERJEE
L17	LR Plot No:- 1313/1815, LR Khatian No:- 8180	Owner: মল্লিকা ব্যানার্জী, Gurdian: মৃত শমুনাথ, Address: নিজ , Classification: বাস, Area: 0.01000000 Acre,	MALLIKA BANERJEE
L18	LR Plot No:- 1312, LR Khatian No:- 8178	Owner: জয়া চ্যাটার্জী, Gurdian: কৃষ্ণদাস চ্যাটার্জী, Address: নিজ , Classification: পুকুর, Area: 0.01000000 Acre,	JAYA CHATTERJEE
L19	LR Plot No:- 1312, LR Khatian No:- 8177	Owner: দেবশীষ ব্যানার্জী, Gurdian: মৃত শমুনাথ, Address: নিজ , Classification: পুকুর, Area: 0.01000000 Acre,	DEBASISH BANERJEE
L20	LR Plot No:- 1312, LR Khatian No:- 8179	Owner: ডলি মুখার্জী, Gurdian: সুহেলু , Address: নিজ , Classification: পুকুর, Area: 0.01000000 Acre,	DOLLY MUKHERJEE
L21	LR Plot No:- 1312, LR Khatian No:- 8180	Owner: মল্লিকা ব্যানার্জী, Gurdian: মৃত শমুনাথ, Address: নিজ , Classification: পুকুর, Area: 0.01000000 Acre,	MALLIKA BANERJEE
L22	LR Plot No:- 1313, LR Khatian No:- 9182	Owner: সমীর রায় চৌধুরী, Gurdian: বিমল রায় চৌধুরী, Address: নিজ , Classification: বাগান, Area: 0.08000000 Acre,	SAMIR ROY CHOWDHURY

L24	LR Plot No:- 1313, LR Khatian No:- 9183	Owner:সমীর রায় চৌধুরী, Gurdian:মৃত বিমল রায় চৌধুরী, Address:রেকজোয়ানী, খানা-রাজারহাট, জেলা:- উত্তর ২৪ পরগনা, Classification:বাগান, Area:0.07000000 Acre,	SAMIR ROY CHOWDHURY
L25	LR Plot No:- 1313, LR Khatian No:- 9181	Owner:সৌমেন রায় চৌধুরী, Gurdian:সমীর রায় চৌধুরী, Address:নিজ , Classification:বাগান, Area:0.08000000 Acre,	SOUMEN ROY CHOWDHURY
L25	LR Plot No:- 1313, LR Khatian No:- 9189	Owner:মৌসুমী রায়চৌধুরী, Gurdian:সমীর রায়চৌধুরী, Address:নিজ , Classification:বাগান, Area:0.08000000 Acre,	MOUSUMI ROY CHOWDHURY
L26	LR Plot No:- 1313/1815, LR Khatian No:- 9183	Owner:সমীর রায় চৌধুরী, Gurdian:মৃত বিমল রায় চৌধুরী, Address:রেকজোয়ানী, খানা-রাজারহাট, জেলা:- উত্তর ২৪ পরগনা, Classification:বাগান, Area:0.06000000 Acre,	SAMIR ROY CHOWDHURY

Endorsement For Deed Number : I - 152320725 / 2022

11-2022
Certificate of Market Value(WB PUVI rules of 2001)

certified that the market value of this property which is the subject matter of the deed has been assessed at Rs
1,00,121/-

Sanjoy Basak

Sanjoy Basak
ADDITIONAL DISTRICT SUB-REGISTRAR
OFFICE OF THE A.D.S.R. RAJARHAT
North 24-Parganas, West Bengal

On 25-11-2022

Presentation(Under Section 52 & Rule 22A(3) 46(1), W.B. Registration Rules, 1962)

Presented for registration at 16:15 hrs on 25-11-2022, at the Private residence by ANGSU PRAKASH MUKHERJEE ,
one of the Claimants,

W.B. Registration Rules, 1962)

is admitted on 25/11/2022 by 1. ANGSU PRAKASH MUKHERJEE, Son of Late RASHBEHARI MUKHERJEE, RECKJOANI, P O RAJARHAT, Thana: Rajarhat, North 24-Parganas, WEST BENGAL, India, PIN - 700135, by caste Hindu, by Profession Retired Person, 2. PRABHAT KUMAR MUKHERJEE, Alias PRABHAT MUKHERJEE, Son of Late RASHBEHARI MUKHERJEE, RECKJOANI, P O RAJARHAT, Thana: Rajarhat, North 24-Parganas, WEST BENGAL, India, PIN - 700135, by caste Hindu, by Profession Business, 3. ARATI MUKHERJEE, Daughter of Late RASHBEHARI MUKHERJEE, RECKJOANI, P O RAJARHAT, Thana: Rajarhat, North 24-Parganas, WEST BENGAL, India, PIN - 700135, by caste Hindu, by Profession House wife, 4. SAMIR ROY CHOWDHURY, Son of Late BIMAL ROY CHOWDHURY, RECKJOANI, P O RAJARHAT, Thana: Rajarhat, North 24-Parganas, WEST BENGAL, India, PIN - 700135, by caste Hindu, by Profession Student, 5. SOUMEN ROY CHOWDHURY, Son of SAMIR ROY CHOWDHURY, RECKJOANI, P O RAJARHAT, Thana: Rajarhat, North 24-Parganas, WEST BENGAL, India, PIN - 700135, by caste Hindu, by Profession House wife, 6. MOUSUMI ROY CHOWDHURY, Wife of SAMIR ROY CHOWDHURY, RECKJOANI, P O RAJARHAT, Thana: Rajarhat, North 24-Parganas, WEST BENGAL, India, PIN - 700135, by caste Hindu, by Profession House wife, 7. JAYA CHATTERJEE, Wife of KRISHNA DAS CHATTERJEE, RECKJOANI, P O RAJARHAT, Thana: Shyampukur, Kolkata, WEST BENGAL, India, PIN - 700005, by caste Hindu, by Profession House wife, 8. DEBASISH BANERJEE, Son of Late SAMBHU NATH BANERJEE, RAJARHAT, Thana: Rajarhat, North 24-Parganas, WEST BENGAL, India, PIN - 700135, by caste Hindu, by Profession Business, 9. DOLLY MUKHERJEE, Wife of SUBHENDU MUKHERJEE, RECKJOANI, P O RAJARHAT, Thana: Rajarhat, North 24-Parganas, WEST BENGAL, India, PIN - 700135, by caste Hindu, by Profession House wife, 10. MALLIKA BANERJEE, Daughter of Late SAMBHU NATH BANERJEE, RECKJOANI, P O RAJARHAT, Thana: Rajarhat, North 24-Parganas, WEST BENGAL, India, PIN - 700135, by caste Hindu, by Profession House wife, 11. ANGSU PRAKASH MUKHERJEE, Son of Late RASHBEHARI MUKHERJEE, RECKJOANI, P O RAJARHAT, Thana: Rajarhat, North 24-Parganas, WEST BENGAL, India, PIN - 700135, by caste Hindu, by Profession Retired Person, 12. PRABHAT KUMAR MUKHERJEE, Alias PRABHAT MUKHERJEE, Son of Late RASHBEHARI MUKHERJEE, RECKJOANI, P O RAJARHAT, Thana: Rajarhat, North 24-Parganas, WEST BENGAL, India, PIN - 700135, by caste Hindu, by Profession Business, 13. ARATI MUKHERJEE, Daughter of Late RASHBEHARI MUKHERJEE, RECKJOANI, P O RAJARHAT, Thana: Rajarhat, North 24-Parganas, WEST BENGAL, India, PIN - 700135, by caste Hindu, by Profession House wife, 14. SAMIR ROY CHOWDHURY, Son of Late BIMAL ROY CHOWDHURY, RECKJOANI, P O RAJARHAT, Thana: Rajarhat, North 24-Parganas, WEST BENGAL, India, PIN - 700135, by caste Hindu, by Profession Service, 15. SOUMEN ROY CHOWDHURY, Son of SAMIR ROY CHOWDHURY, RECKJOANI, P O RAJARHAT, Thana: Rajarhat, North 24-Parganas, WEST BENGAL, India, PIN - 700135, by caste Hindu, by Profession Student, 16. MOUSUMI ROY CHOWDHURY, Wife of SAMIR ROY CHOWDHURY, RECKJOANI, P O RAJARHAT, Thana: Rajarhat, North 24-Parganas, WEST BENGAL, India, PIN - 700135, by caste Hindu, by Profession House wife, 17. JAYA CHATTERJEE, Wife of KRISHNA DAS CHATTERJEE, SHRI ARABINDA SARANI, P O HATKHOLA, Thana: Shyampukur, Kolkata, WEST BENGAL, India, PIN - 700005, by caste Hindu, by Profession House wife, 18. DEBASISH BANERJEE, Son of Late SAMBHU NATH BANERJEE, RECKJOANI, P O RAJARHAT, Thana: Rajarhat, North 24-Parganas, WEST BENGAL, India, PIN - 700135, by caste Hindu, by Profession Business, 19. DOLLY MUKHERJEE, Wife of SUBHENDU MUKHERJEE, RECKJOANI, P O RAJARHAT, Thana: Rajarhat, North 24-Parganas, WEST BENGAL, India, PIN - 700135, by caste Hindu, by Profession House wife, 20. MALLIKA BANERJEE, Daughter of Late SAMBHU NATH BANERJEE, RECKJOANI, P O RAJARHAT, Thana: Rajarhat, North 24-Parganas, WEST BENGAL, India, PIN - 700135, by caste Hindu, by Profession House wife

Indetified by PRANAB KUMAR RAYCHAUDHURI, , Son of Late NANU RAYCHAUDHURI, RECKJOANI, P O RAJARHAT, Thana: Rajarhat, North 24-Parganas, WEST BENGAL, India, PIN - 700135, by caste Hindu, by profession Business

Sanjoy Basak

Sanjoy Basak
ADDITIONAL DISTRICT SUB-REGISTRAR
OFFICE OF THE A.D.S.R. RAJARHAT
North 24-Parganas, West Bengal

2022
of Fees
Certified that required Registration Fees payable for this document is Rs 5,97,015.00/- (A(1) = Rs 5,97,001.00/- ,E =
and Registration Fees paid by by online = Rs 5,97,015/-
Description of Online Payment using Government Receipt Portal System (GRIPS), Finance Department, Govt. of WB
Online on 25/11/2022 9:39AM with Govt. Ref. No: 192022230189985491 on 25-11-2022, Amount Rs: 5,97,015/-,
Bank: State Bank of India (SBIN0000001), Ref. No. CKV4897025 on 25-11-2022, Head of Account 0030-03-104-001-
16

Payment of Stamp Duty

Certified that required Stamp Duty payable for this document is Rs. 2,98,521/- and Stamp Duty paid by by online = Rs
2,98,021/-
Description of Online Payment using Government Receipt Portal System (GRIPS), Finance Department, Govt. of WB
Online on 25/11/2022 9:39AM with Govt. Ref. No: 192022230189985491 on 25-11-2022, Amount Rs: 2,98,021/-,
Bank: State Bank of India (SBIN0000001), Ref. No. CKV4897025 on 25-11-2022, Head of Account 0030-02-103-003-
02

Sanjoy Basak

Sanjoy Basak
ADDITIONAL DISTRICT SUB-REGISTRAR
OFFICE OF THE A.D.S.R. RAJARHAT
North 24-Parganas, West Bengal

On 23-12-2022

Certificate of Admissibility(Rule 43,W.B. Registration Rules 1962)

Admissible under rule 21 of West Bengal Registration Rule, 1962 duly stamped under schedule 1A, Article number : 23
of Indian Stamp Act 1899.

Payment of Stamp Duty

Certified that required Stamp Duty payable for this document is Rs. 2,98,521/- and Stamp Duty paid by Stamp Rs
500.00/-
Description of Stamp
1. Stamp: Type: Impressed, Serial no 4393, Amount: Rs.500.00/-, Date of Purchase: 24/11/2022, Vendor name: Mita
Dutta

Sanjoy Basak

Sanjoy Basak
ADDITIONAL DISTRICT SUB-REGISTRAR
OFFICE OF THE A.D.S.R. RAJARHAT
North 24-Parganas, West Bengal

Registration under section 60 and Rule 69.
In Book - I
No 1523-2022, Page from 774356 to 774406
No 152320725 for the year 2022.



Digitally signed by SANJOY BASAK
Date: 2022.12.29 17:36:12 +05:30
Reason: Digital Signing of Deed.

Sanjoy Basak

(Sanjoy Basak) 2022/12/29 05:36:12 PM
ADDITIONAL DISTRICT SUB-REGISTRAR
OFFICE OF THE A.D.S.R. RAJARHAT
West Bengal.

(This document is digitally signed.)